



Saginaw County Road Commission 2014 Annual Report



3020 Sheridan Avenue
Saginaw, MI 48601
(989) 752-6140
www.scrs-mi.org

INDEX

Submission of Officers.....1

Managing Director.....2

Fact Sheet.....3

Evolution of a Road Commission.....4-5

Project Selection.....6

Michigan Transportation Fund
 & Michigan Transportation Economic Development Funds.....7

Overall Accomplishments.....8

Primary Road Projects.....9

Local Road Projects.....10-12

Allocation of Funds.....13

2014 Project Map.....14

Primary Maintenance by Townships.....15-18

Local Maintenance by Townships.....19-22

Miscellaneous Maintenance Projects.....23-24

Township Contributions.....25

Statement of Revenues & Expenditures.....26

Balance Sheet.....27

Organizational Chart.....28



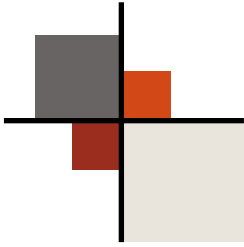

SUBMISSION OF OFFICERS

ANNUAL REPORT OF THE BOARD OF COUNTY ROAD COMMISSIONERS OF SAGINAW COUNTY, MICHIGAN

Fiscal Year Ending December 31, 2014



Todd M. Hare
Chairperson



John D. Sangster
Vice-Chairperson



Deb Kestner
Member



Richard H. Crannell, P.E.
Member



Ronald L. Sholtz
Member

The Saginaw County Road Commission takes pleasure in submitting to you and the people of Saginaw County our fiscal year 2014 annual report in compliance with the provisions of Public Act 283 of 1909, as amended. Information in this report covers the fiscal year of January 1, 2014 through December 31, 2014.

Included in our annual report is a brief history of the Saginaw County Road Commission, an outline of our funding sources, a list of our activities related to construction and maintenance of our roads, bridges and miscellaneous items and our expenditures for the 2014 fiscal year.

Respectfully submitted,

**BOARD OF COUNTY ROAD COMMISSIONERS
OF THE COUNTY OF SAGINAW**

Todd M. Hare, Chairperson



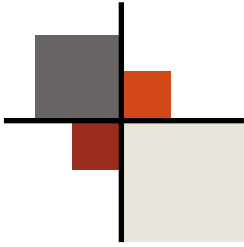

MANAGING DIRECTOR

As Managing Director, Dennis Borchard is responsible for overseeing the day-to-day activities of the Road Commission. The Manager has several department heads who report to him to keep him abreast of the operations of the Road Commission.



Dennis L. Borchard

The goal of the Saginaw County Road Commission remains steadfast: using our expertise, energy and funds to provide the safest and most convenient road system possible, and to contribute to economic development and a high quality of life throughout the county.

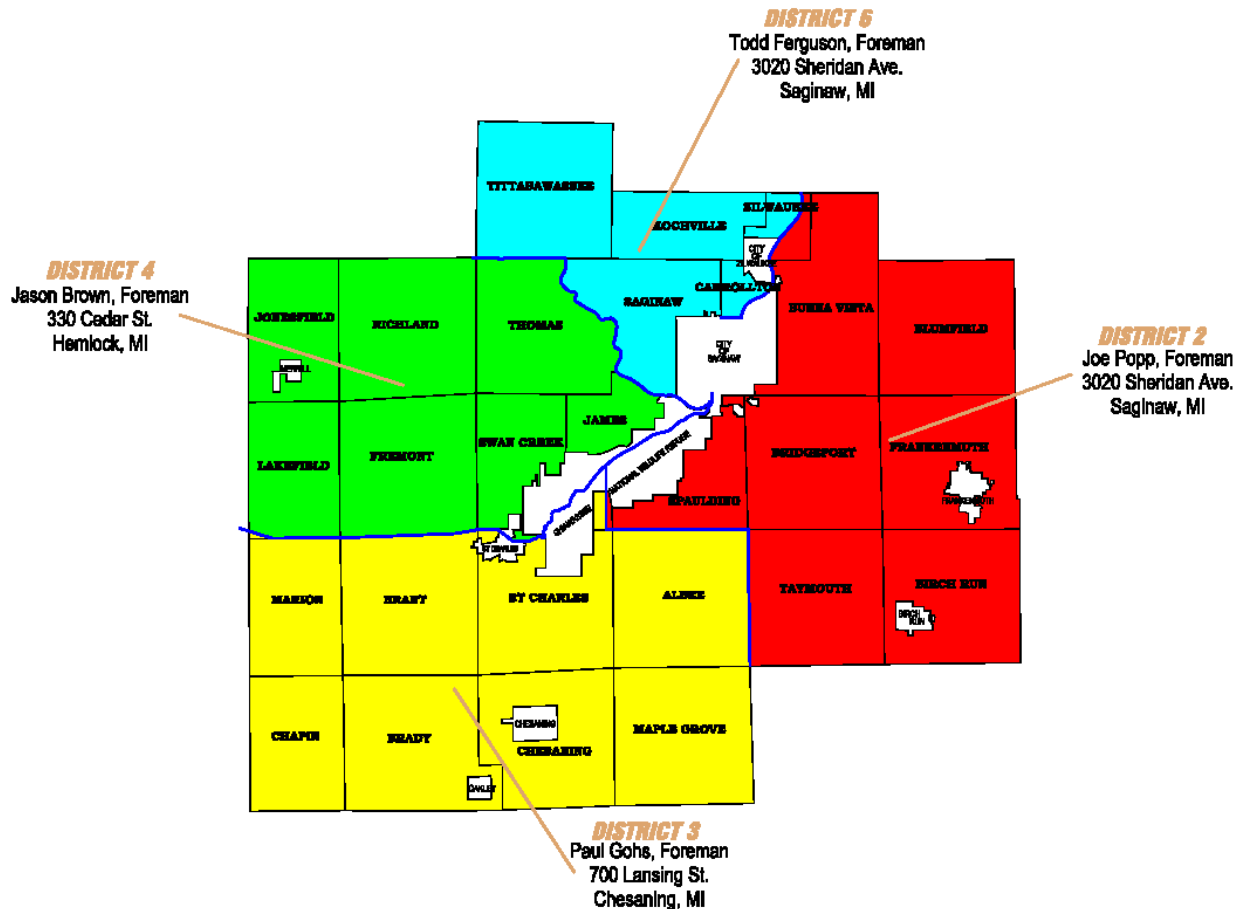

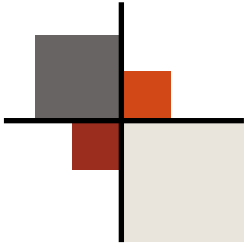

FACT SHEET

Saginaw County residents:	200,169	Total miles of road	1,849.38
Residents of townships served:	142,059	Miles of primary road	499.24
Road Commission employees:	59	Miles of local road	1350.14
Commissioners:	5		

Townships served:	27	Albee	Kochville
		Birch Run	Lakefield
		Blumfield	Maple Grove
		Brady	Marion
		Brant	Richland
		Bridgeport	Saginaw
		Buena Vista	St. Charles
		Carrollton	Spaulding
		Chapin	Swan Creek
		Chesaning	Taymouth
		Frankenmuth	Thomas
		Fremont	Tittabawassee
		James	Zilwaukee
		Jonesfield	

Total Revenue	\$20,209,260
Michigan Transportation Fund (MTF)	\$12,713,091
Federal, State, Twp. & Other Revenue	\$ 7,496,169
Miles of 2014 construction projects	9.45
Bridges replaced	0
Miles of local roads chip sealed	34
Miles of primary roads chip sealed	0
Miles of gravel placed roads	32
Tons of salt used	11,960.76



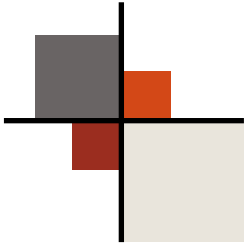

EVOLUTION OF A ROAD COMMISSION

From the 1850's through the 1920's, state law permitted townships to exercise responsibility for building and maintaining local roads. A highway commissioner in each organized township had the duty to oversee the road system.

Near the turn of the century, the popularization of the bicycle and the invention of the automobile caused major changes in our highway system. The first significant improvements in the administration of Michigan's highways came in 1883 with the passage of Public Act 278, which provided for a somewhat experimental district of eight townships to be established in our neighboring county of Bay. This action was found to promote needed consistency, create a more efficient road agency and provide a means to raise funds for road improvements.

In 1893, the "County Road Law" was passed which encouraged other counties to follow the lead of Bay County. But most, including Saginaw, still preferred the "one commissioner per township" method. In 1909, legislative action created county road commissions as we know them today. Each county had the option to adopt the new law, which Saginaw County did in December of 1917. The first three road commissioners appointed in Saginaw County were L.L. Pearson of Saginaw, Peter Bell of Taymouth Township and Edward Perrot of Chesaning.

The first county highway engineer appointed by the new board was David A. Nichol and the first county road superintendent was William Sommerfield.

Originally, the Road Commission had offices in the courthouse, but in the early 1920's moved to 312 Court Street because of the need for more space.

At that time (circa 1925), there were three separate systems of roads in the county. One was the county road system, owned and maintained by the county; another was the state trunk line system, maintained by the state; and the third was a system of township roads, maintained by each township.

In 1931, Michigan Legislature passed the McNitt Act, which transferred all the township roads to county jurisdiction over a five-year period. The McNitt Act also established right-of-way widths and mandated that funding come from a portion of the weight and gasoline taxes. During the five-year period, the Saginaw County road mileage jumped from 340 miles to over 1,500 miles.



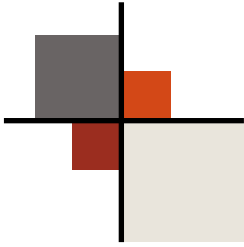

EVOLUTION OF A ROAD COMMISSION

In the late 1930's the Saginaw County Road Commission came to realize they had to improve the many miles of dirt roads that existed. Most of these roads were originally constructed by digging a ditch on each side and using the spoils to build up the roadbed. This made for narrow roads of clay and silt that were nearly impassible during rainy periods, especially in the spring. The proposed solution was to cover the roads with gravel or crushed stone and then prime and seal with an asphaltic material covered with stone chips, or pave with a bituminous asphalt mixture or in some instances, concrete.

By 1951, the Saginaw County Road Commission had an ongoing paving program. The passage of Public Act 51 in 1951 clearly defined the activities of county road commissions and defined funding sources and how they are divided to build and maintain roads and bridges. The Saginaw County Road Commission was placing a hard surface on over 60 miles of roads each year by the end of the 1950's. Most of these roads were narrow and any ditches that existed were close to the edge of the roadway.

By the middle of the 1970's the proliferation of legal actions and the rising cost of insurance ended the practice of just blacktopping the existing roadways. Roads needed to be constructed to meet current standards of highway safety. Today, the Road Commission prefers a minimum roadway width of 20 feet with 6-foot shoulders for low volume local roads. Primary roads need to be a minimum of 22 feet wide with 6-foot shoulders. Moving the ditches out to accommodate a wider, safer roadway is almost always necessary when considering even a seemingly insignificant paving project. The combination of roadway width, shoulders, fore-slopes, ditches and back-slopes take up all of the 66-foot wide right-of-way. Once the ditching is re-done and the roadway is paved to the proper width, then it's back to preserving the pavement we have by chip and seal, crack sealing or periodic paving.

The increasing cost of rebuilding roadways and bridges combined with little increase of revenue over the past eight years or so, make the Road Commission's job difficult at best. Managing our road and bridge assets by using a "mix of fixes" is the way of the future. It has been proven that fixing the worst first will lead to having more bad roadways than good. Preserving our good roadways and rebuilding a few of our bad roadways each year will gradually improve the average condition of our entire system.

Throughout its evolution, from the end of the year of 1917 to today, the Saginaw County Road Commission has constantly changed to meet its customer's needs. For its 94 years of existence the Road Commission has been and always will be committed to using the best available expertise and maximizing the available funds to make sure Saginaw County has the safest, most convenient road system possible.



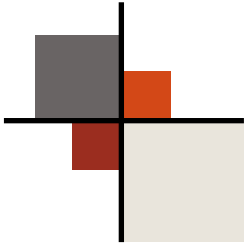

PROJECT SELECTION

The Road Commission establishes road improvement priorities for the primary road system. Annually, our staff develops an improvement plan spanning five years that is based on engineering assessments and on site reviews. This plan is reviewed and projects are undertaken, based on current and future road needs and anticipated funding.

In December 2013, the Saginaw County Road Commission adopted a \$21,444,410 budget for FY2014. The plan includes such projects as resurfacing, reconstructing and widening roads; converting certain roads to all-season status; safety projects; bridge replacements; and upgrading some traffic signals.

For the local road system, road improvement priorities are developed in conjunction with township governments. The Road Commission maintains a local road participation fund program that provides funds for each township that must be matched on a dollar-for-dollar basis for road improvement projects. These projects include local road preservation/structural improvements and construction/capacity improvement projects, such as installation of significant storm sewer improvements, chip seal, asphalt overlays and road reconstruction. The financial commitment of township boards and residents through the years has proved invaluable. These partnerships help provide better service to our joint constituencies.



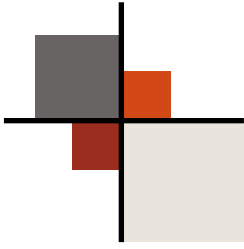

Michigan Transportation Fund and Michigan Transportation Economic Development Funds

MICHIGAN TRANSPORTATION FUNDS

The Michigan Transportation Fund (MTF) is the repository of fuel taxes and vehicle registration fees collected by the state and the principal source of road commission funding. The collected funds are distributed to the Michigan Department of Transportation (MDOT), 535 cities and villages and 83 county road commissions using a formula based on variables that include the density of population, road mileage by classification and collected vehicle registration fees.

Our 2014 general allocations revenue from the MTF increased by \$104,765 from 2013. Even with this slight increase, our current MTF is still less than our 1998 MTF revenue, and expenses have increased from 100-400% over the last 5 years.

MICHIGAN TRANSPORTATION ECONOMIC DEVELOPMENT FUNDS

The Road Commission also works diligently to qualify for special sources of revenue for road improvement projects from other state and federal sources.

State sources include local bridge funds and Transportation Economic Development Funds, or TEDF. Categories of TEDF funding include:

Category A, competitively available for upgrading roads that will benefit certain state sanctioned, targeted industries that will create or retain a specified number of jobs.

Category D, to upgrade to all-season-road status and to develop a network of roads that are not weight-restricted during seasonal road thaws.

Category F, competitively available for upgrading roads to all-season status to complete broken links in the all-season-road network in the urban area.

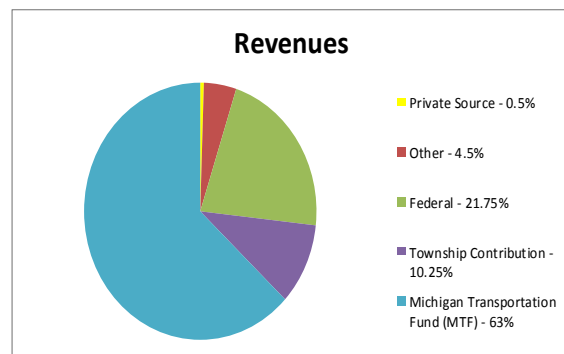
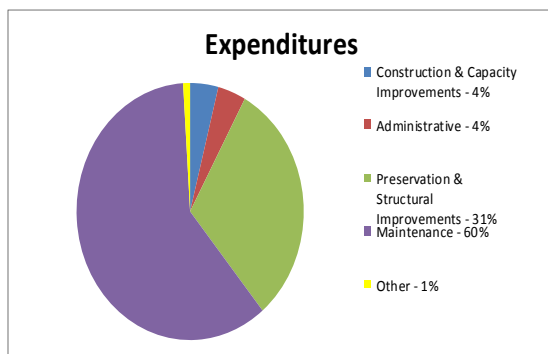

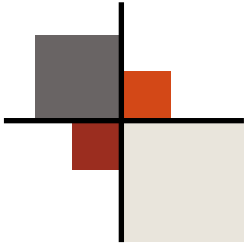

OVERALL ACCOMPLISHMENTS

During 2014, the Saginaw County Road Commission devoted more than \$8,467,150 million to various betterment activities, including paving, chip seal, brining and gravelling. More than 6.67 miles of road were paved. And to preserve the capital investment in our roads, approximately 34 miles of road were chip sealed, as well as the addition of turn lanes at intersections, shoulder paving, upgrading of traffic signals and new traffic signal installations at several intersections.

The county road system continues to grow. During the past three years, 1.41 miles of roads have been added to the public road system. These new roads are the result of developments that built roads to public road standards and then were donated for public use. These new roads require public road service. While this growth reflects positively on the quality of life and business climate of Saginaw County, there continues to be concern about decreasing revenues while demands for service are increasing.

Maintenance Mode



2014 Crack Sealing Program



2014 Chip Seal Program



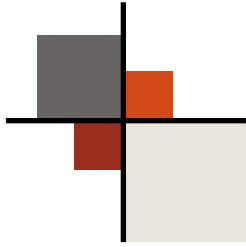

PRIMARY ROAD PROJECTS

<u>Township</u>	Road Name	From Location	To Location	Description	Amount, Incl. Distributive
Saginaw	Wieneke	Weiss	Shattuck	Design-Survey	\$ 15,012.81
451 Primary Roads - Construction/Capacity Improvements					\$ 15,012.81
Albee	Gary/Gasper	Fergus	Lincoln	Design-Survey	\$ 59,234.03
Bridgeport	Williamson	King	Iowa	Cross-Culvert Replacement	\$ 7,040.99
Jonesfield	Frost	Chapin	and Merrill	Cross-Culvert Replacement	\$ 2,469.66
Kochville	Tittabawassee	@	Fashion Square	Traffic Signal	\$ 8,082.52
Marion	Marion	Meridian	Fenmore	Design-Survey	\$ 5,982.25
Saginaw	Brockway	City Limits	Center	Paving	\$ 145,280.36
Saginaw	McCarty	Bay	Fashion Square	Design-Survey	\$ 32,655.73
Saginaw	Hemmeter	State	Brockway	Design-Survey	\$ 70,711.11
Saginaw	Mackinaw	At Rail Tracks	At Rail Tracks	Drainage Only	\$ 27,842.68
Saginaw	Shattuck	@	Sherwood School	Traffic Signal	\$ 14,967.62
St. Charles	Fergus	Shiawassee River	Gasper	Drainage & Paving	\$ 315,497.12
Taymouth	Nichols	Willard	Burt	Cross-Culvert Replacement	\$ 2,037.47
Thomas	River	Frost	Dice	Design-Survey	\$ 35,762.17
Thomas	Miller	Gratiot	State	Drainage & Paving	\$ 1,752,195.81
Tittabawassee	Freeland	M-47	Rail Tracks	Design-Survey	\$ 64,524.37
459-Primary Roads - Preservation/Structural Improvements					\$ 2,544,283.89
Chesaning	Gary	over	Shiawassee River	Design-Survey	\$ 49,857.08
460-Primary Bridges - Preservation/Structural Improvements					\$ 49,857.08



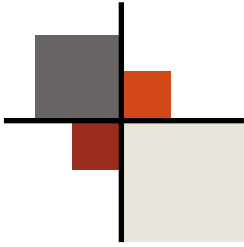

LOCAL ROAD PROJECTS

Township	Name	From Location	To Location	Description	Length	Account Number	Sub Account	Amount, Incl. Distributive
Albee	Rathbun	Sheridan	East (M-13)	Cross-Culvert Replacement	0.10	489C0112	081	\$ 3,070.34
Albee	Burt	Sheridan	East	Cross-Culvert Replacement	0.10	489C0125	291	\$ 7,121.60
Albee	Bueche	over	Koepke Drain	Design-Survey	0.10	49000102	281	\$ 2,157.51
								\$ 12,349.45
Birch Run	Burt	Block	Gera (M-83)	Chip and Seal	1.00	48900226	009	\$ 93,515.01
Birch Run	Burt	Block	Reese	Chip and Seal	1.00	48900236	009	\$ 38,918.29
Birch Run	Lange	800 Ft west of	Maple	Cross-Culvert Replacement	0.10	489C0205	251	\$ 3,391.84
Birch Run	Block	Busch	Rathbun	Cross-Culvert Replacement	0.10	489C0211	441	\$ 4,519.21
								\$ 140,344.35
Blumfield	Gera	South of	Hack	Drainage Only	0.50	48900311	431	\$ 37,156.39
								\$ 37,156.39
Brady	Ferden	M-52	Fordney	Chip and Seal	1.00	48900425	051	\$ 9,100.00
Brady	Harris	M-52	Fordney	Cross-Culvert Replacement	0.10	489C0401	121	\$ 4,545.48
Brady	Peet	Steel	Steel	Cross-Culvert Replacement	0.10	489C0418	061	\$ 3,230.33
Brady	Johnstone	Raucholz	Hemlock	Cross-Culvert Replacement	0.10	489C0434	011	\$ 2,202.59
								\$ 19,078.40
Brant	Fordney	at Schroeder	at Schroeder	Cross-Culvert Replacement	0.10	489C0511	351	\$ 2,654.76
Brant	Burt	@ Fowler	@ Fowler	Cross-Culvert Replacement	0.10	489C0529	241	\$ 8,503.31
								\$ 11,158.07
Bridgeport	Baker	Portsmouth	Reimer	Chip and Seal	1.00	48900612	211	\$ 38,820.00
Bridgeport	Townline	Blackmar	I-75	Drainage & Paving	0.50	48900635	031	\$ 107,712.68
								\$ 146,532.68
Buena Vista	Munger	Portsmouth	Fred	Crush Shape & Chip and Seal	1.03	48900707	001	\$ 71,857.93
								\$ 71,857.93
Carrollton	Hiawatha	Cherokee	Dead End to West	Crush Shape & Chip and Seal	0.10	48900801	041	\$ 7,637.63
								\$ 7,637.63
Chapin	Peet	@ Merrill	@ Merrill	Cross-Culvert Replacement	0.10	489C0915	071	\$ 3,196.00
Chapin	Fenmore	Wickie	Peet	Cross-Culvert Replacement	0.10	489C0916	201	\$ 2,117.94
								\$ 5,313.94



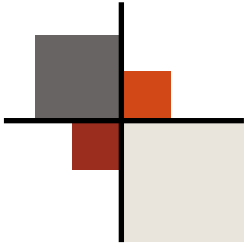

LOCAL ROAD PROJECTS

Township	Name	From Location	To Location	Description	Length	Account Number	Sub Account	Amount, Incl. Distributive
Frankenmuth	Stern	Dehmel	Beyer	Crush Shape & Chip and Seal	1.00	48901121	171	\$ 67,610.70
Frankenmuth	Dehmel	Warnick	Townline	Design-Survey	0.52	48901133	411	\$ 45,218.77
Frankenmuth	Townline	Gera	Block	Cross-Culvert Replacement	0.10	489C1135	051	\$ 4,139.04
Frankenmuth	Dehmel	over	Dead Creek	Bridge Replacement	0.10	49001134	411	\$ 35,024.63
								\$ 151,993.14
Fremont	Roosevelt	Fordney	Orr	Cross-Culvert Replacement	0.10	489C1212	201	\$ 3,433.77
								\$ 3,433.77
James	Weigl	Swan Creek	Trinklein	Drainage	0.05	48901306	231	\$ 4,320.56
James	Hart	Miller	River	Design-Survey	1.02	48901312	021	\$ 82,842.86
James	Strieter	Spot Locations	Spot Locations	Drainage Only	0.10	48901331	011	\$ 1,189.57
								\$ 88,352.99
Kochville	Heidi Lane	Heidi Lane	Heidi Lane	Cross-Culvert Replacement	0.10	489C1536	021	\$ 2,465.87
								\$ 2,465.87
Lakefield	Lakefield	Meridian	Fenmore	Cross-Culvert Replacement	0.10	489C1621	061	\$ 3,222.94
								\$ 3,222.94
Maple Grove	Bueche	M-57	Volkmer	Drainage & Paving	1.00	48901714	251	\$ 211,124.87
Maple Grove	Chesaning	East	M-13	Cross-Culvert Replacement	0.10	489C1701	151	\$ 2,825.82
Maple Grove	Volkmer	East	Bueche	Cross-Culvert Replacement	0.10	489C1711	121	\$ 2,683.90
Maple Grove	East	Chesaning	and Volkmer	Cross-Culvert Replacement	0.10	489C1711	311	\$ 2,752.28
Maple Grove	Bueche	at Ditch	at Ditch	Cross-Culvert Replacement	0.10	489C1735	071	\$ 2,639.84
								\$ 222,026.71
Marion	Brant	Merrill	Fenmore	Cross-Culvert Replacement	0.10	489C1815	062	\$ 2,218.10
Marion	Marion	@ Chapin	@ Chapin	Cross-Culvert Replacement	0.10	489C1823	051	\$ 2,798.82
								\$ 5,016.92
Richland	Ederer	Raucholz	Fordney	Crush Shape & Chip and Seal	0.50	48901935	031	\$ 34,175.03
Richland	Geddes	Hemlock	Brennan	Cross-Culvert Replacement	0.10	489C1921	101	\$ 2,546.26
Richland	Pruess	over	McClellan Drain	Bridge Replacement	0.10	49001913	541	\$ 19,024.38
								\$ 55,745.67



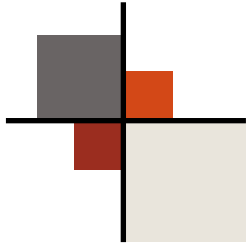

LOCAL ROAD PROJECTS

Township	Name	From Location	To Location	Description	Length	Account Number	Sub Account	Amount, Incl. Distributive
Saginaw	Berkshire	W. Berkshire	N. Berkshire	Drainage Only	0.10	48902018	011	\$ 6,704.66
Saginaw	Jonquil	Mackinaw	Loganberry	Traffic Signal	0.10	489T2004	011	\$ 5,239.79
Saginaw	Cobblestone Point			Subdivisions donated by developers	0.36	4810SUBD	059	\$ 264,884.72
Saginaw	Meadowlark Estates			Subdivisions donated by developers	0.29	4810SUBD	060	\$ 189,690.45
								\$ 466,519.62
Spaulding	Treanor	Williamson	Dixie Hwy	Drainage & Paving	1.55	48902206	011	\$ 859,319.31
Spaulding	Cole	Evon	Houlihan	Drainage Only	0.10	48902213	341	\$ 2,424.19
								\$ 861,743.50
St. Charles	Gary	Sharon	McKeighan	Cross-Culvert Replacement	0.10	489C2133	021	\$ 2,830.19
								\$ 2,830.19
Swan Creek	Barber	Thomas	Benkert	Cross-Culvert Replacement	0.10	489C2310	181	\$ 1,549.42
								\$ 1,549.42
Taymouth	Townline	Blackmar	I-75	Drainage & Paving	0.50	48900635	031	\$ 107,712.68
Taymouth	Burt	@ Moorish	@ Moorish	Intersection Improvement	0.10	48902426	031	\$ 29,316.45
Taymouth	Elms	Busch	Lange	Cross-Culvert Replacement	0.10	489C2401	471	\$ 5,049.13
Taymouth	Lange	Marshall	Blackmar	Cross-Culvert Replacement	0.10	489C2402	191	\$ 3,034.74
Taymouth	Dorwood	Verne	Seymour	Cross-Culvert Replacement	0.10	489C2418	251	\$ 3,183.41
								\$ 40,583.73
Thomas	Hardwood Estates	Timberwood	Circlewood	Paving Only	0.60	48902526	041	\$ 349,983.07
Thomas	N. Thomas	M-46	Geddes	Cross-Culvert Replacement	0.10	489C2521	411	\$ 3,220.64
Thomas	Schomaker	M-52	Thomas	Cross-Culvert Replacement	0.10	489C2529	031	\$ 3,136.74
Thomas	Wallace	End of Wallace	End of Wallace	Cross-Culvert Replacement	0.10	489C2530	012	\$ 17,672.37
Thomas	Ederer	Miller	River	Cross-Culvert Replacement	0.10	489C2536	021	\$ 1,891.11
								\$ 375,903.93
Tittabawassee	Vasold	River	Gleaner	Crush Shape & Chip and Seal	1.91	48902629	041	\$ 80,856.78
Tittabawassee	Carter	Hotchkiss	Buck	Cross-Culvert Replacement	0.10	489C2605	421	\$ 3,151.52
Tittabawassee	Gleaner	Buck	and Midland	Cross-Culvert Replacement	0.10	489C2605	291	\$ 48,639.18
Tittabawassee	Gleaner	Buck	Hotchkiss	Cross-Culvert Replacement	0.10	489C2606	371	\$ 2,928.83
Tittabawassee	LaDuke	West of Carter	West of Carter	Cross-Culvert Replacement	0.10	489C2608	271	\$ 5,554.11
Tittabawassee	Wilkinson	Gleaner	Orr	Cross-Culvert Replacement	0.10	489C2619	151	\$ 2,147.19
Tittabawassee	Pierce	Hackett	Garfield	Cross-Culvert Replacement	0.10	489C2626	121	\$ 2,880.25
Tittabawassee	Curve	East of	Gleaner	Cross-Culvert Replacement	0.10	489C2631	021	\$ 3,868.49
Tittabawassee	Webster	Sarle	Freeland	Traffic Signal	0.10	489T2615	451	\$ 7,158.92
								\$ 157,185.27



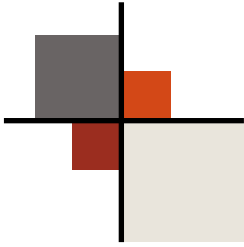

ALLOCATIONS OF FUNDS

Effective 1-1-14

TOWNSHIP	2010 POPULATION	% POPULATION	LOCAL MILEAGE	% MILEAGE	\$ POPULATION	\$ MILEAGE	\$ SUB-TOTAL	CHAP 20 ASSMT	TOTAL
ALBEE	2,160	1.60	42.26	3.13	\$5,547.86	\$10,857.34	\$16,405.20		\$16,405.20
BIRCH RUN	4,478	3.32	55.71	4.13	\$11,501.53	\$14,312.88	\$25,814.41		\$25,814.41
BLUMFIELD	1,960	1.45	60.49	4.48	\$5,034.17	\$15,540.95	\$20,575.11		\$20,575.11
BRADY	1,928	1.43	54.08	4.01	\$4,951.98	\$13,894.10	\$18,846.08		\$18,846.08
BRANT	2,012	1.49	61.92	4.59	\$5,167.73	\$15,908.34	\$21,076.06		\$21,076.06
BRIDGEPORT	10,514	7.79	71.56	5.30	\$27,004.71	\$18,385.02	\$45,389.74	\$4,886.25	\$40,503.49
BUENA VISTA	8,676	6.43	82.26	6.10	\$22,283.90	\$21,134.04	\$43,417.94		\$43,417.94
CARROLLTON	6,103	4.52	28.68	2.13	\$15,675.27	\$7,368.40	\$23,043.66	\$1,374.03	\$21,669.63
CHAPIN	1,060	0.79	36.23	2.68	\$2,722.56	\$9,308.12	\$12,030.68		\$12,030.68
CHESANING	2,265	1.68	36.34	2.69	\$5,817.55	\$9,336.39	\$15,153.93		\$15,153.93
FRANKENMUTH	1,959	1.45	62.60	4.64	\$5,031.60	\$16,083.04	\$21,114.64		\$21,114.64
FREMONT	2,096	1.55	48.72	3.61	\$5,383.48	\$12,517.03	\$17,900.50		\$17,900.50
JAMES	2,023	1.50	17.08	1.27	\$5,195.98	\$4,388.15	\$9,584.13		\$9,584.13
JONESFIELD	889	0.66	31.01	2.30	\$2,283.35	\$7,967.01	\$10,250.37		\$10,250.37
KOCHVILLE	5,078	3.76	31.81	2.36	\$13,042.60	\$8,172.55	\$21,215.15		\$21,215.15
LAKEFIELD	1,029	0.76	28.78	2.13	\$2,642.94	\$7,394.09	\$10,037.03		\$10,037.03
MAPLE GROVE	2,668	1.98	46.40	3.44	\$6,852.63	\$11,920.98	\$18,773.61		\$18,773.61
MARION	923	0.68	32.62	2.42	\$2,370.68	\$8,380.65	\$10,751.33		\$10,751.33
RICHLAND	4,144	3.07	74.91	5.55	\$10,643.67	\$19,245.70	\$29,889.37		\$29,889.37
SAGINAW	40,840	30.25	145.36	10.77	\$104,895.61	\$37,345.54	\$142,241.15	\$9,647.71	\$132,593.44
ST. CHARLES	1,276	0.95	45.99	3.41	\$3,277.35	\$11,815.64	\$15,092.99		\$15,092.99
SPAULDING	2,153	1.59	27.02	2.00	\$5,529.88	\$6,941.91	\$12,471.79		\$12,471.79
SWAN CREEK	2,456	1.82	35.72	2.65	\$6,308.12	\$9,177.10	\$15,485.22		\$15,485.22
TAYMOUTH	4,520	3.35	52.78	3.91	\$11,609.41	\$13,560.11	\$25,169.52		\$25,169.52
THOMAS	11,985	8.88	73.03	5.41	\$30,782.91	\$18,762.69	\$49,545.60		\$49,545.60
TITTABAWASSEE	9,726	7.21	63.22	4.68	\$24,980.77	\$16,242.33	\$41,223.10	\$7,080.00	\$34,143.10
ZILWAUKEE	67	0.05	2.92	0.22	\$172.09	\$750.20	\$922.29		\$922.29
TOTALS	134,988	100.00	1,349.50	100.00	\$346,710.30	\$346,710.30	\$693,420.59	\$22,987.99	\$670,432.60

As of 12-31-13



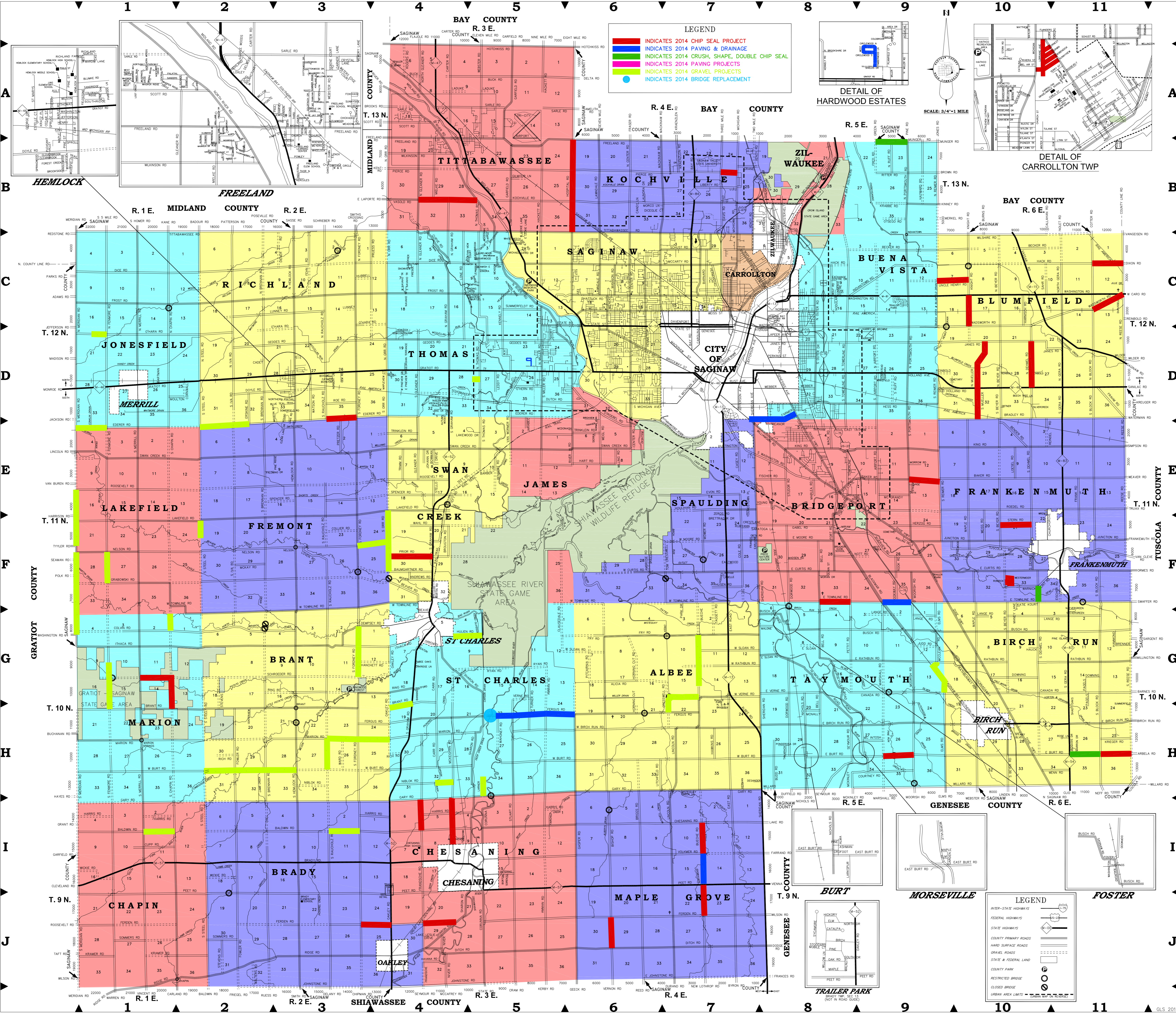

LEGEND

- INDICATES 2014 CHIP SEAL PROJECT
- INDICATES 2014 PAVING & DRAINAGE
- INDICATES 2014 CRUSH, SHAPE, DOUBLE CHIP SEAL
- INDICATES 2014 PAVING PROJECTS
- INDICATES 2014 GRAVEL PROJECTS
- INDICATES 2014 BRIDGE REPLACEMENT

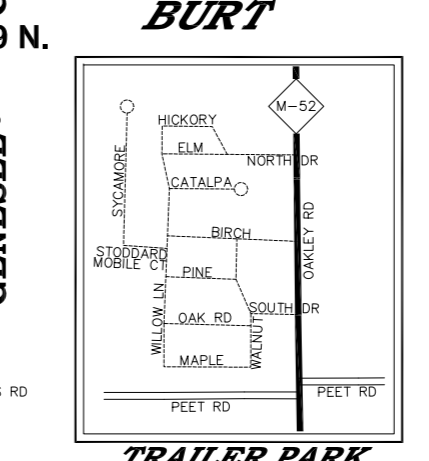
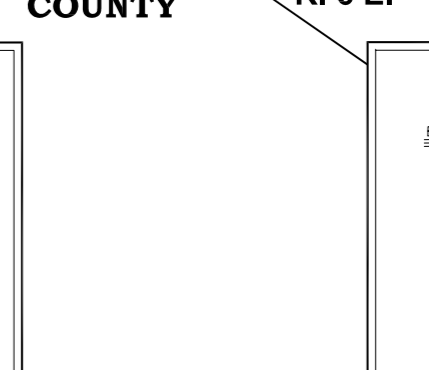
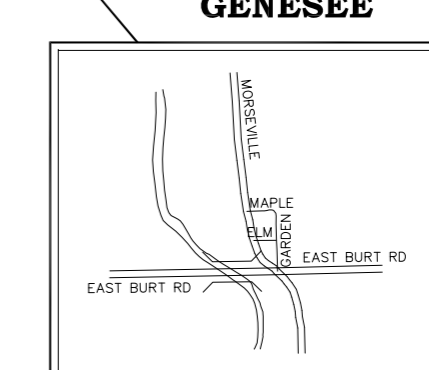
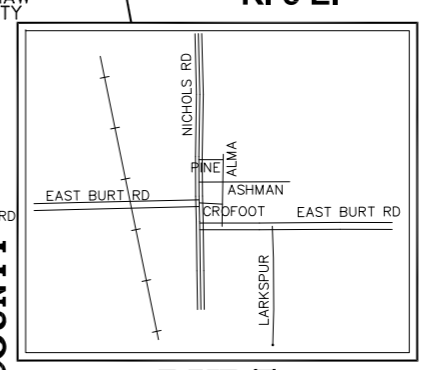
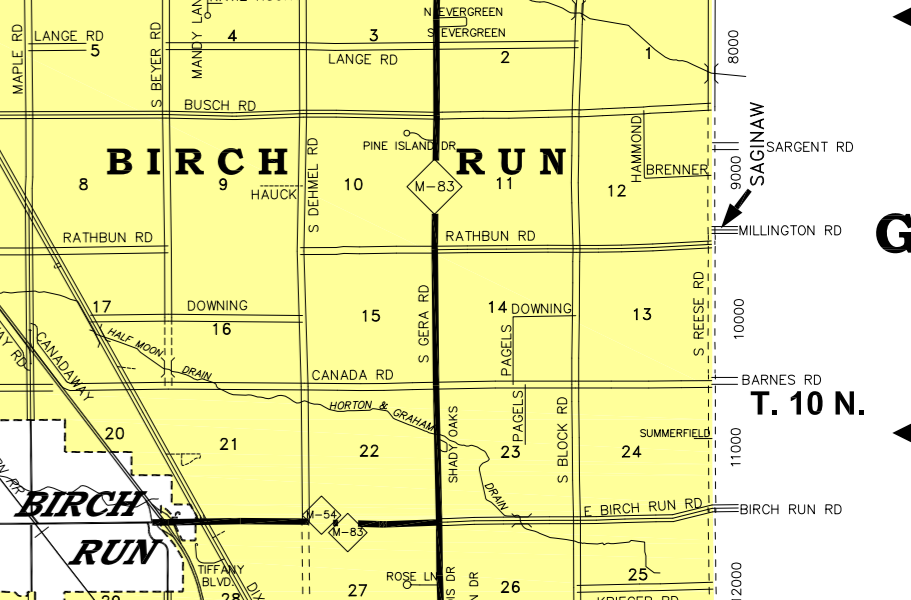
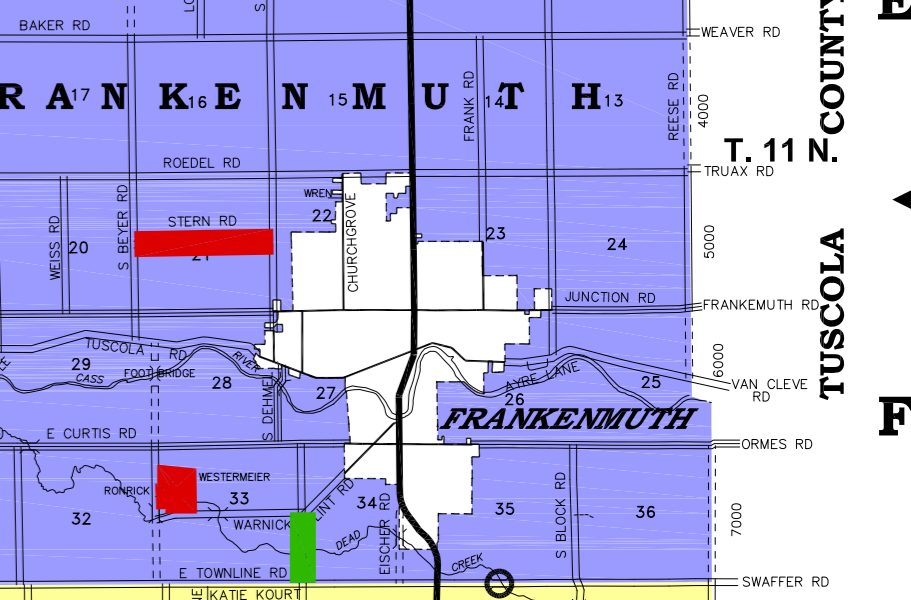
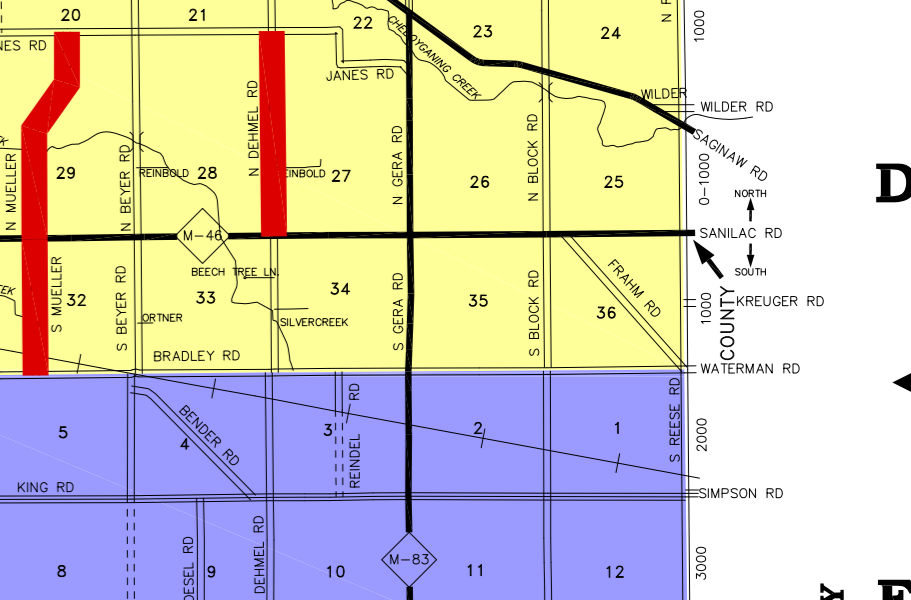
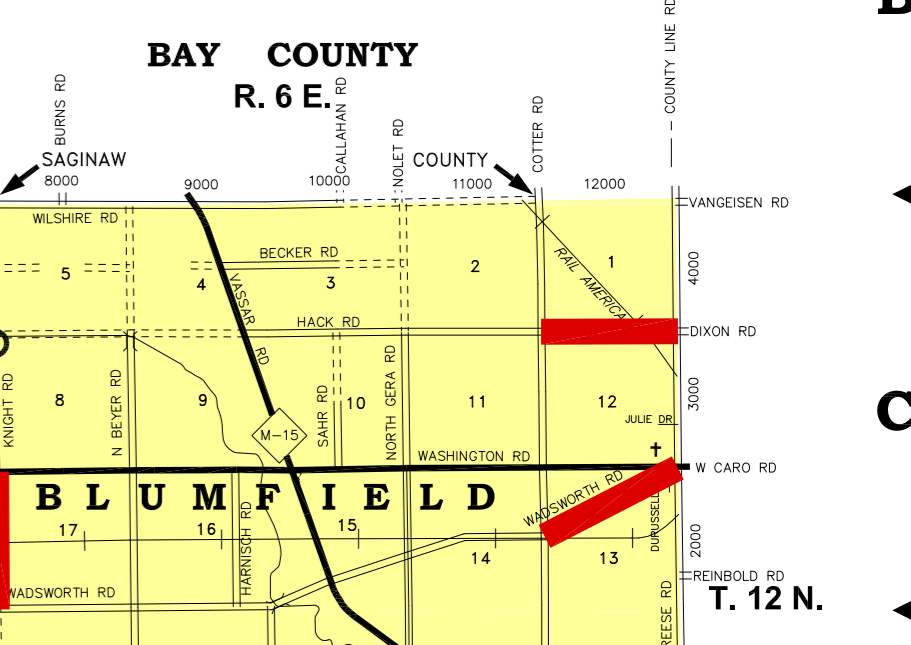
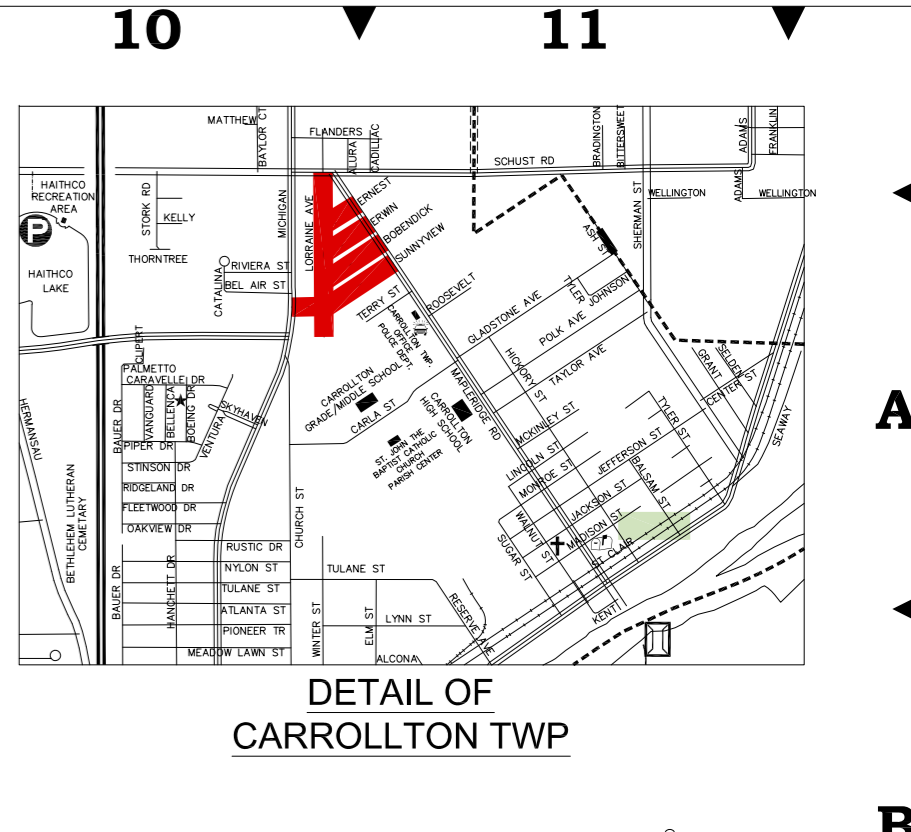
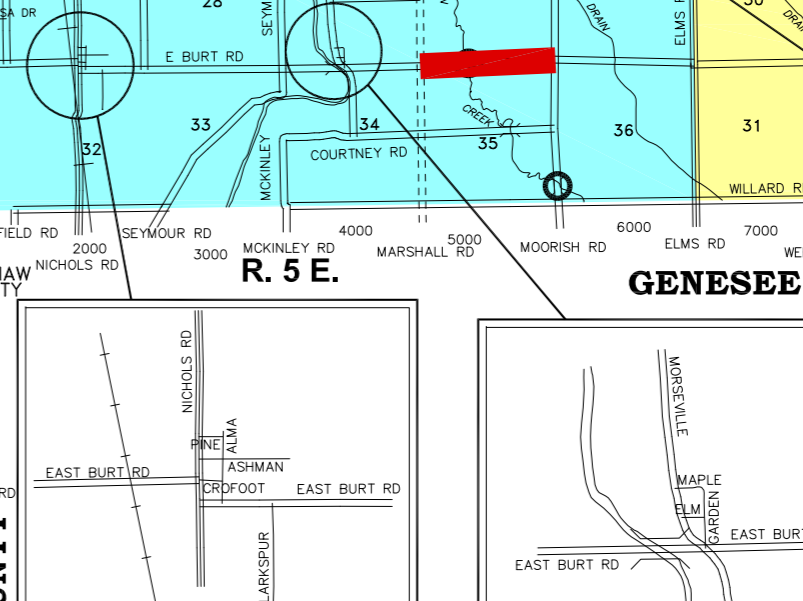
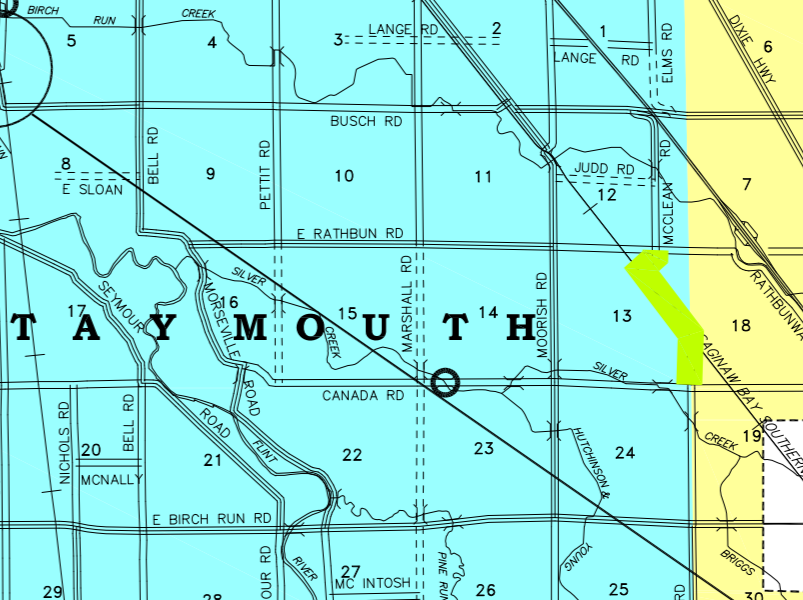
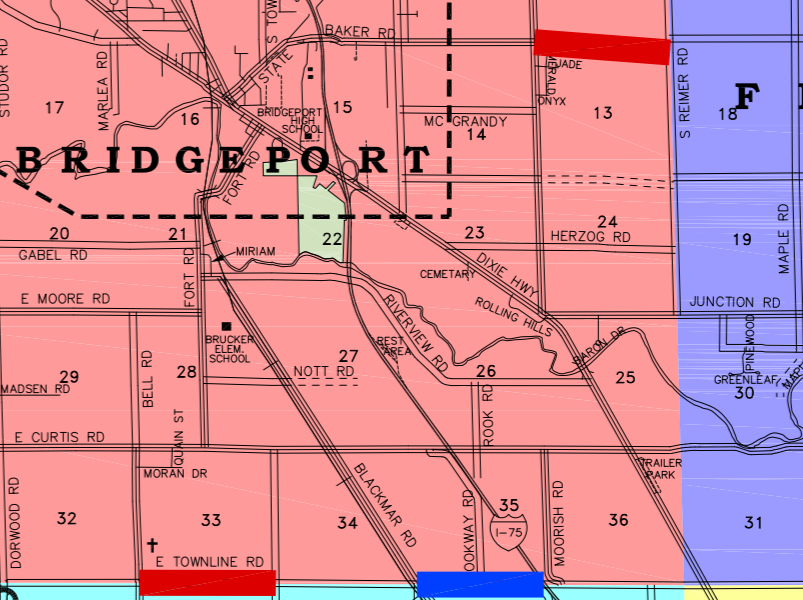
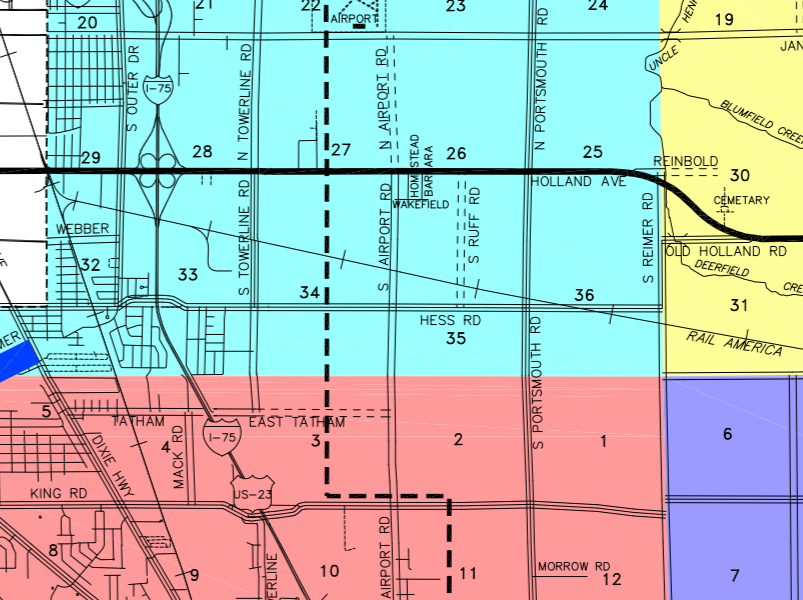
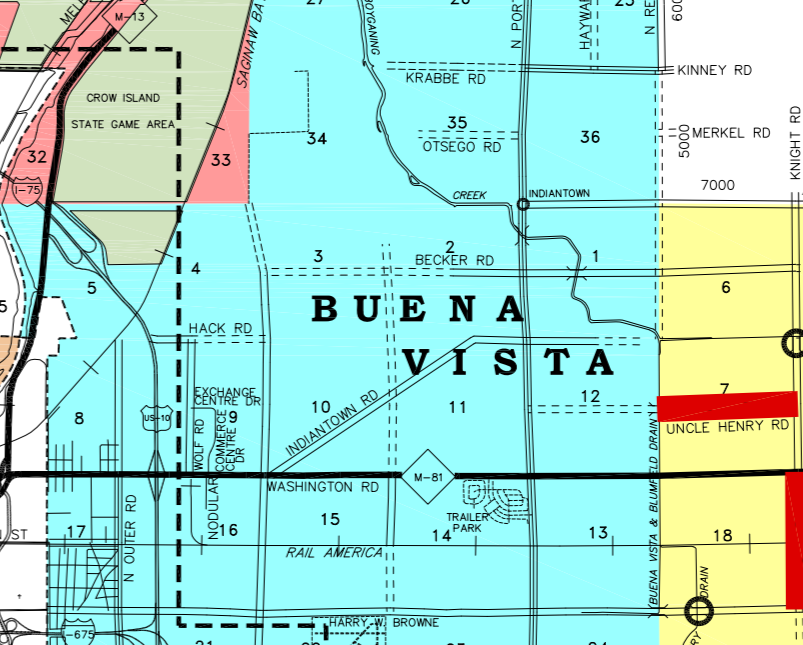
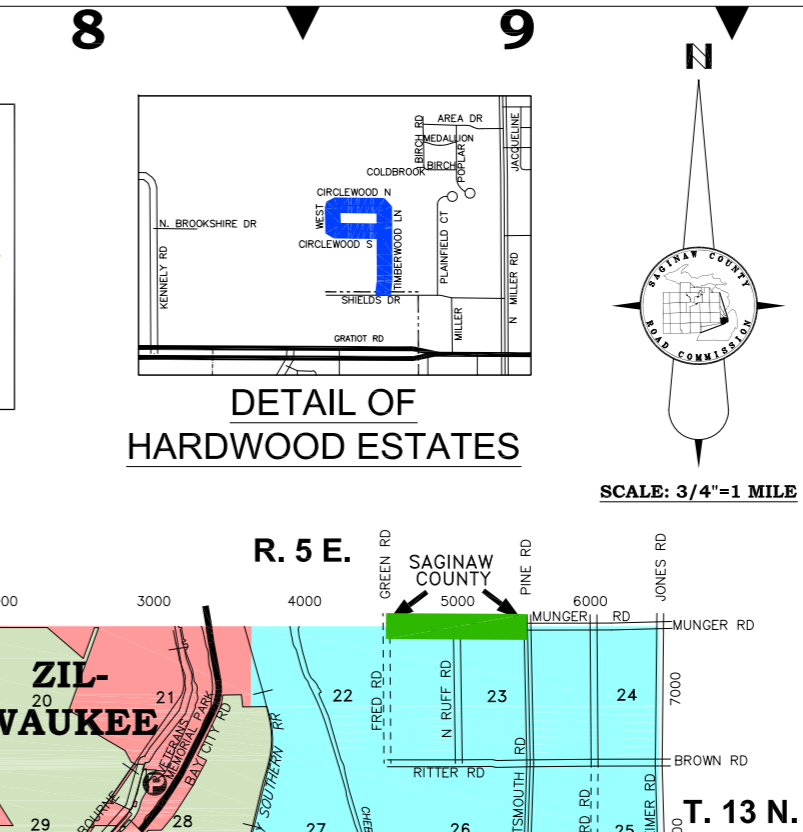
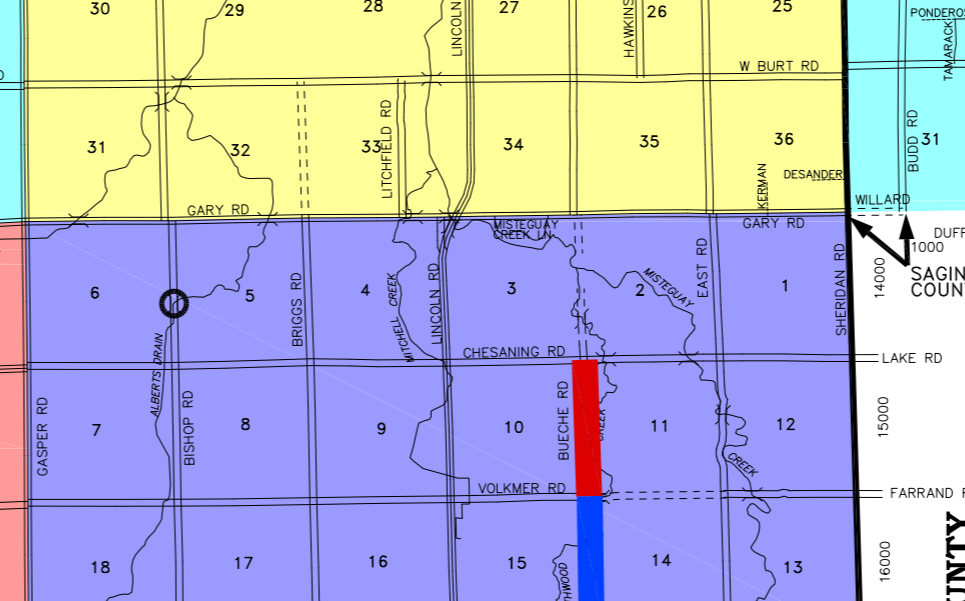
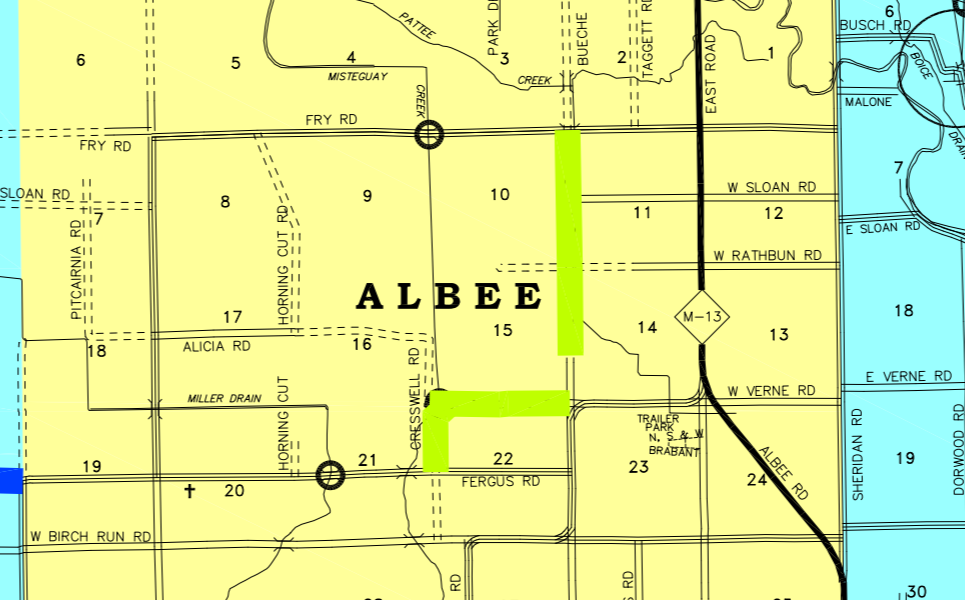
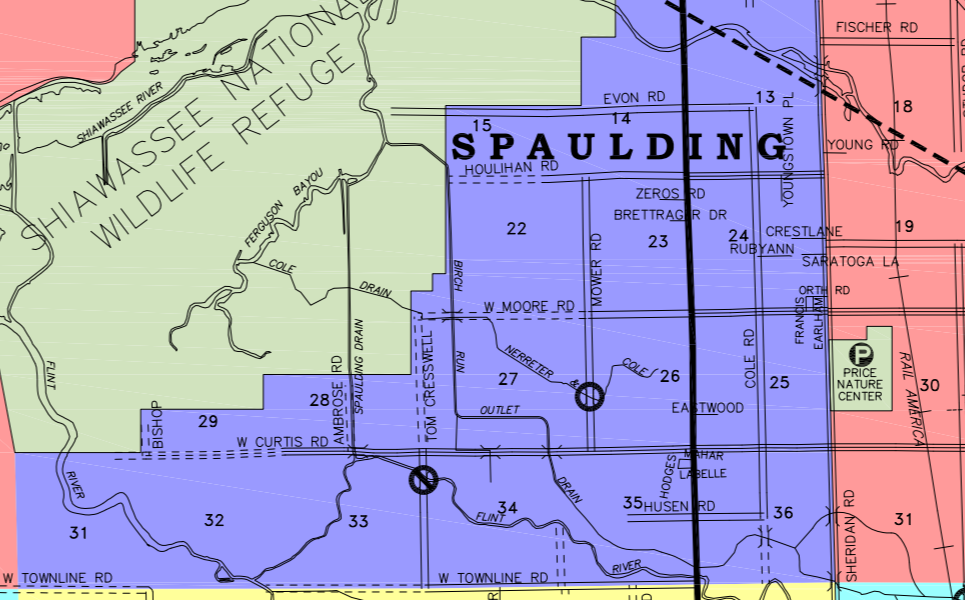
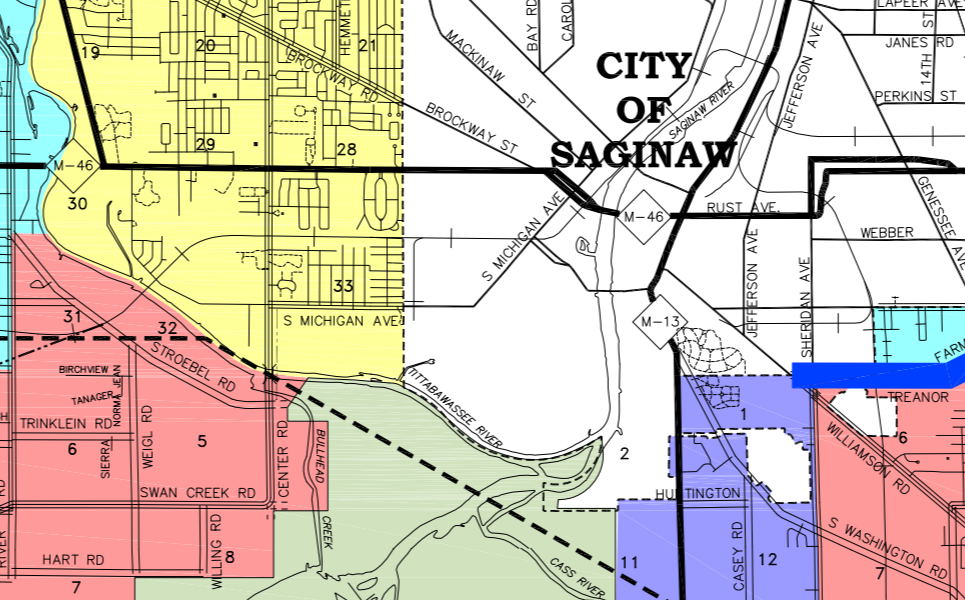
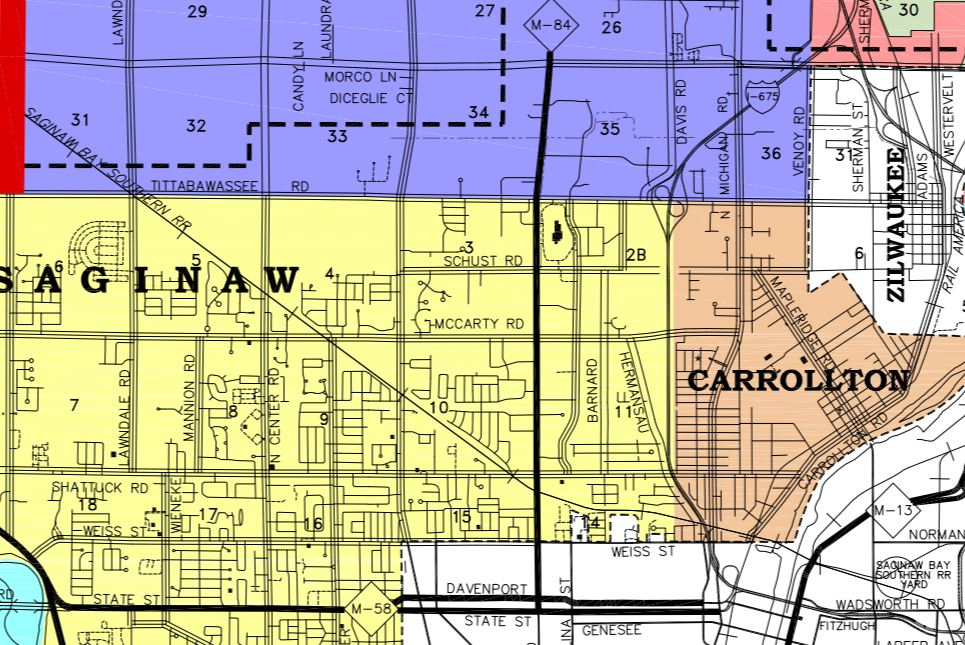
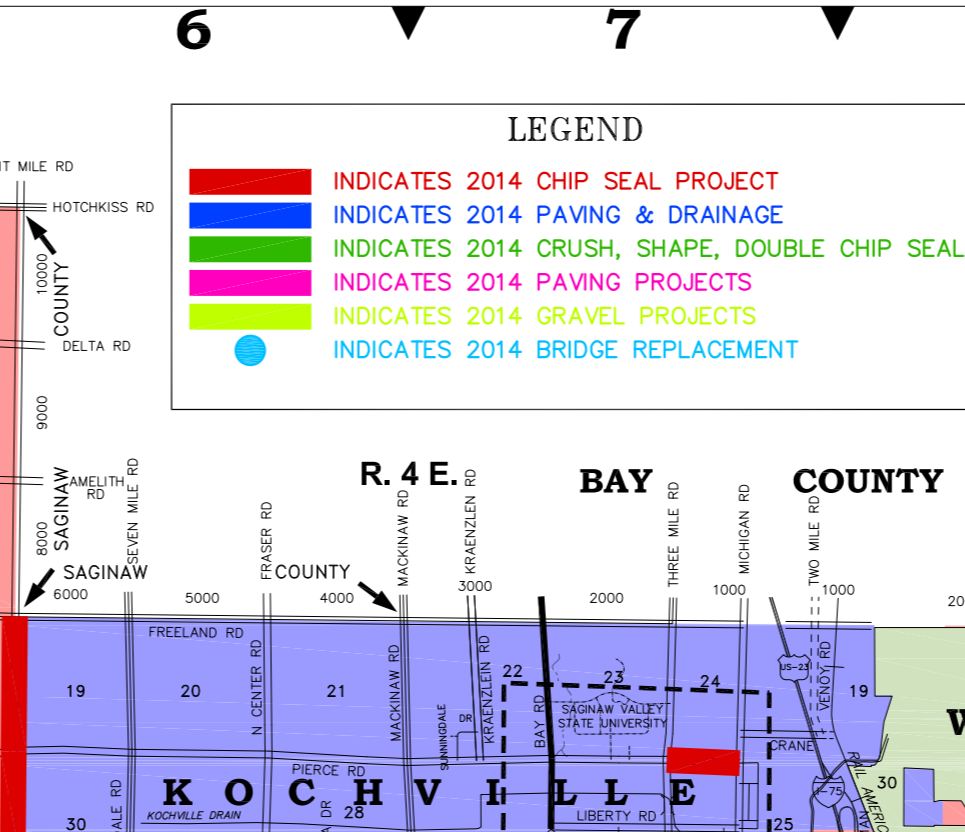
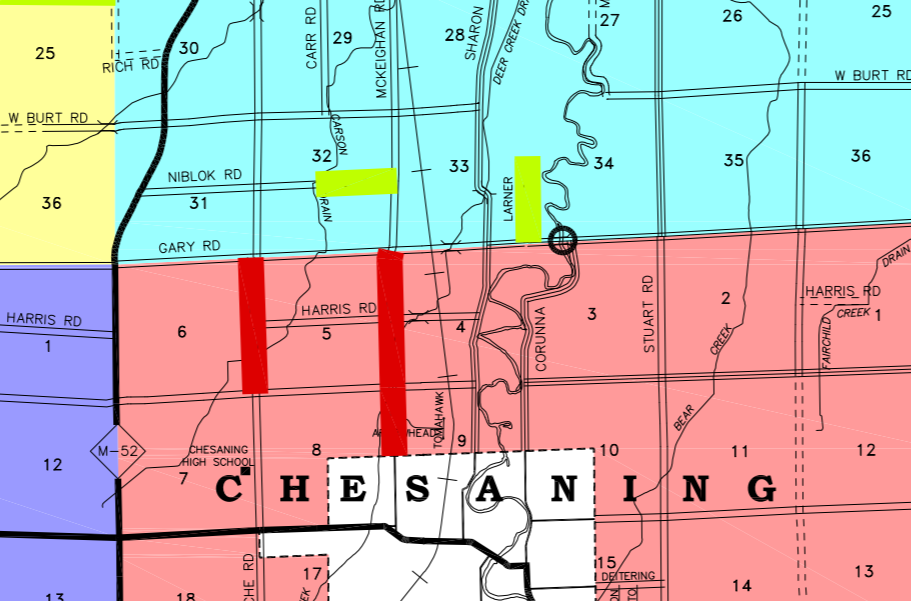
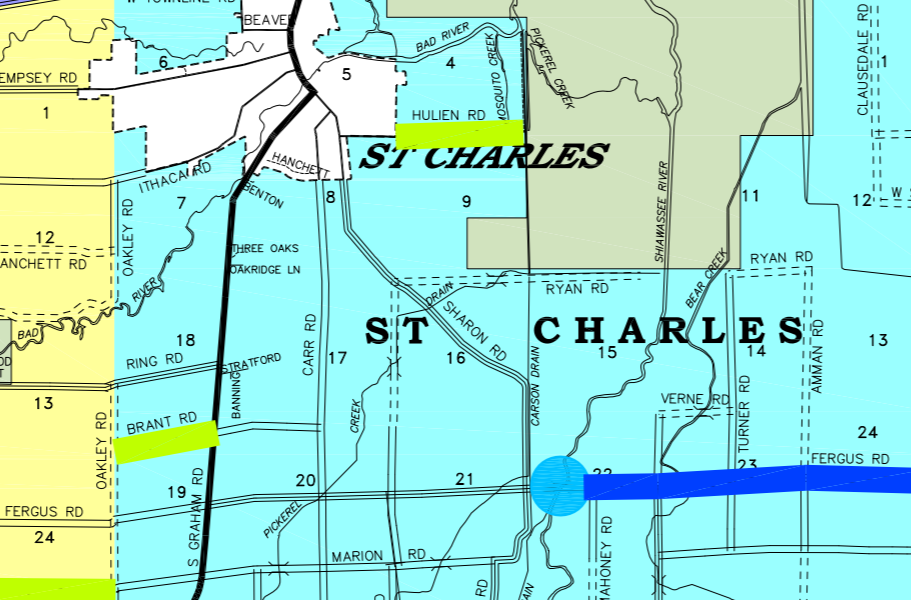
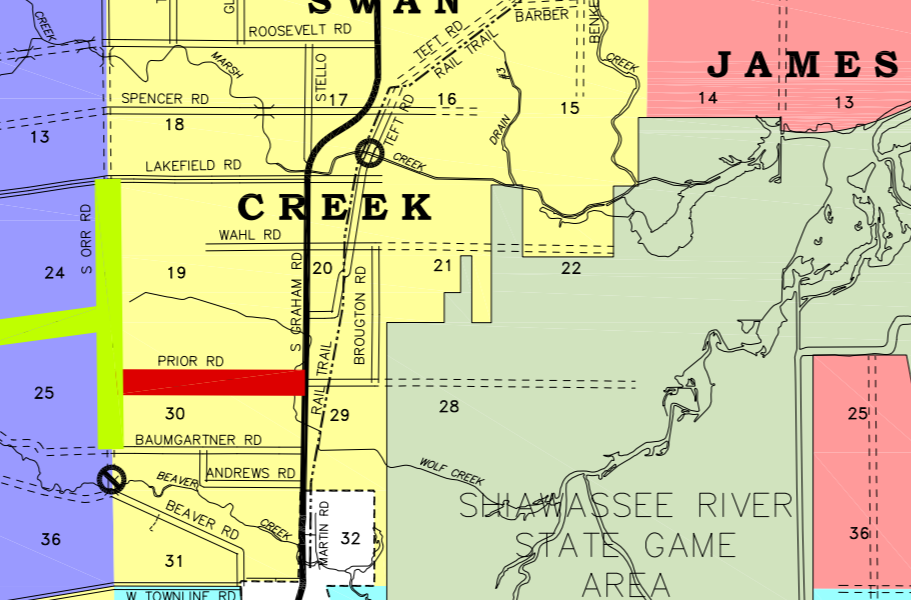
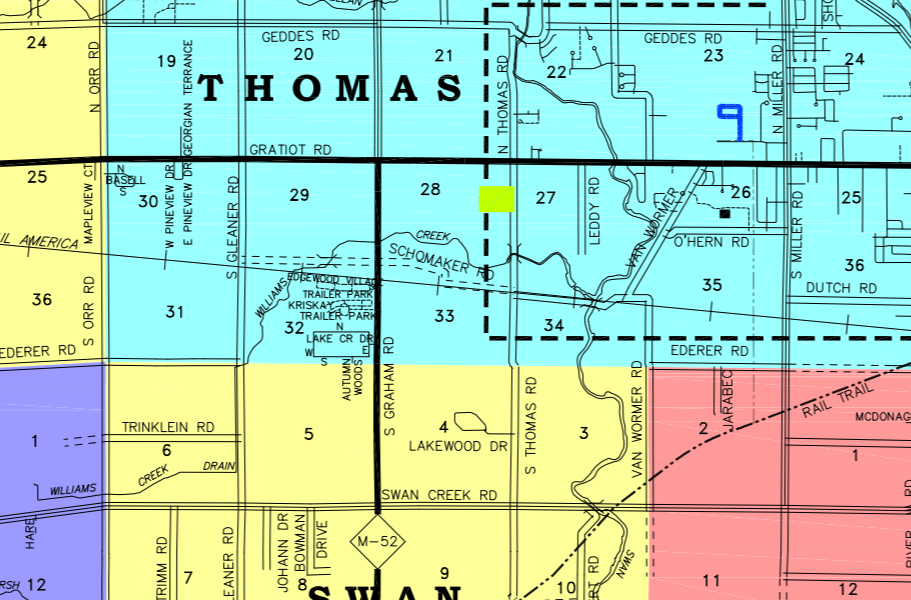
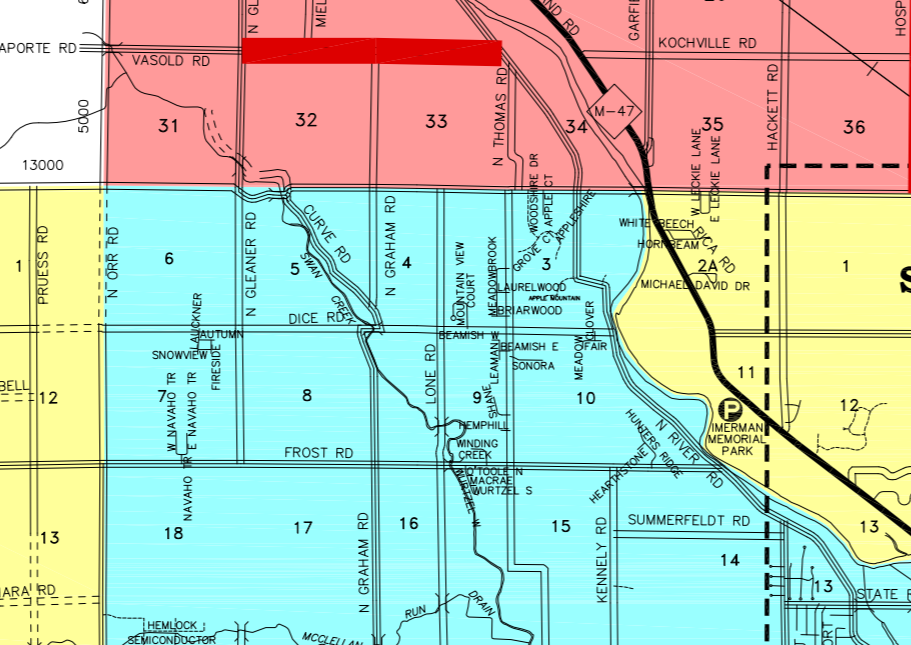
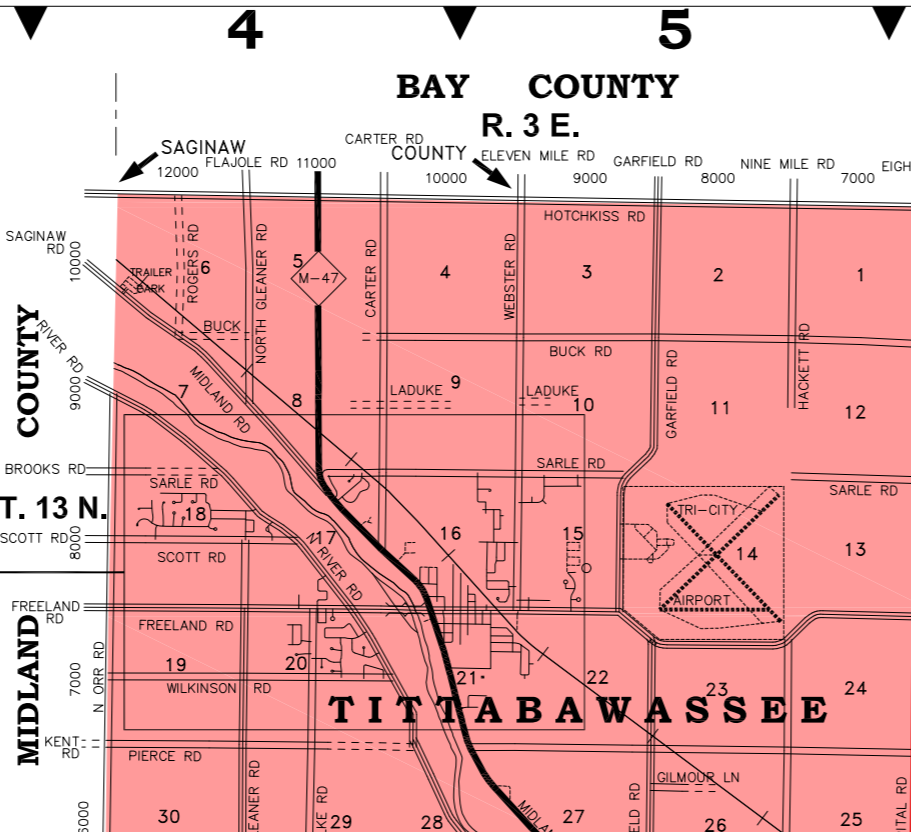
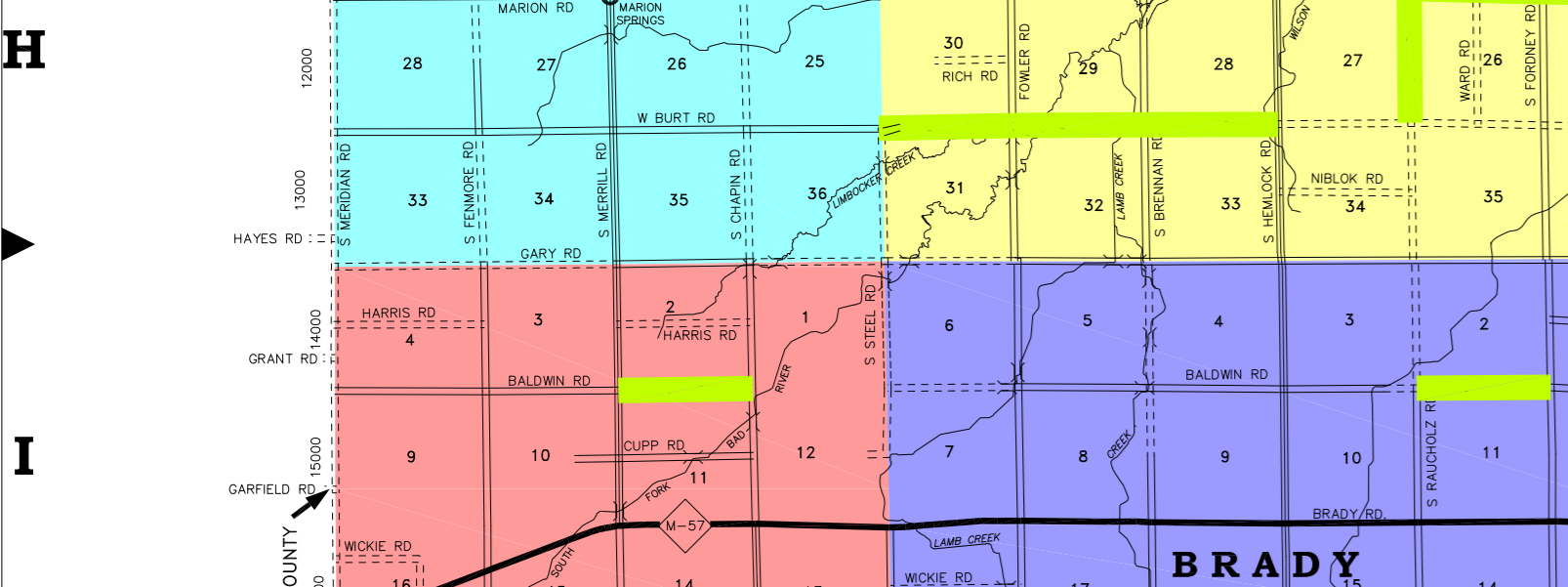
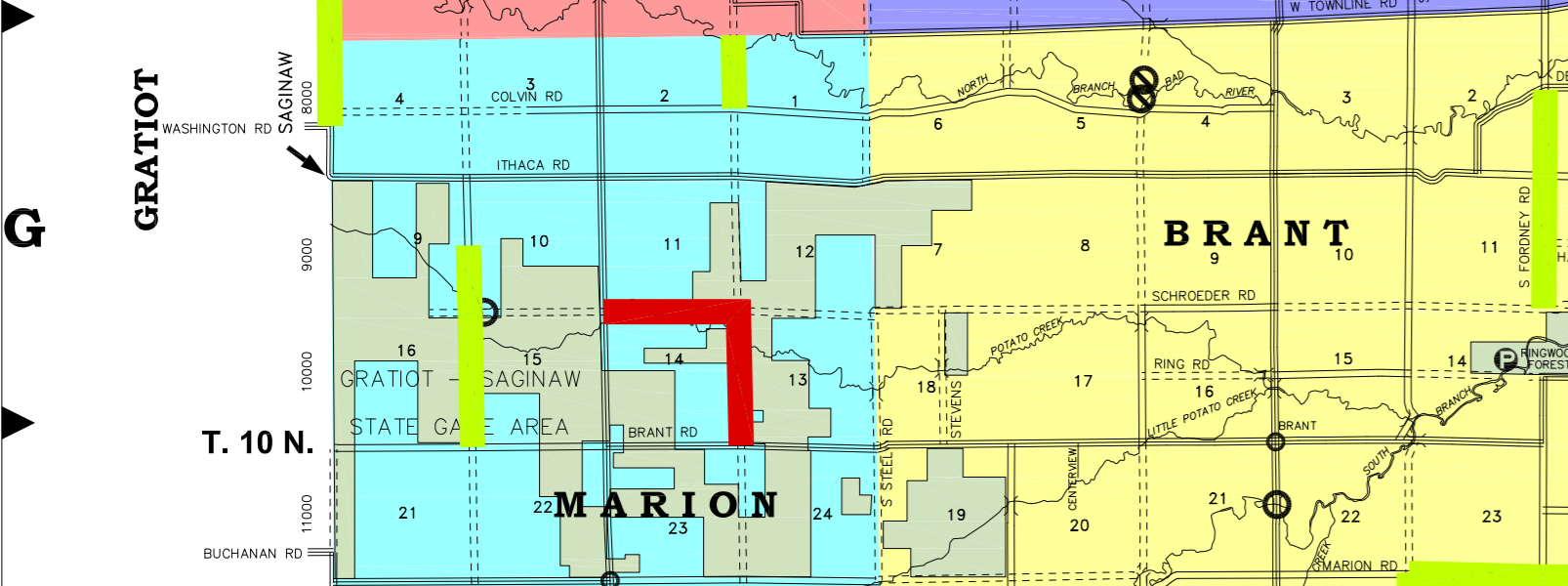
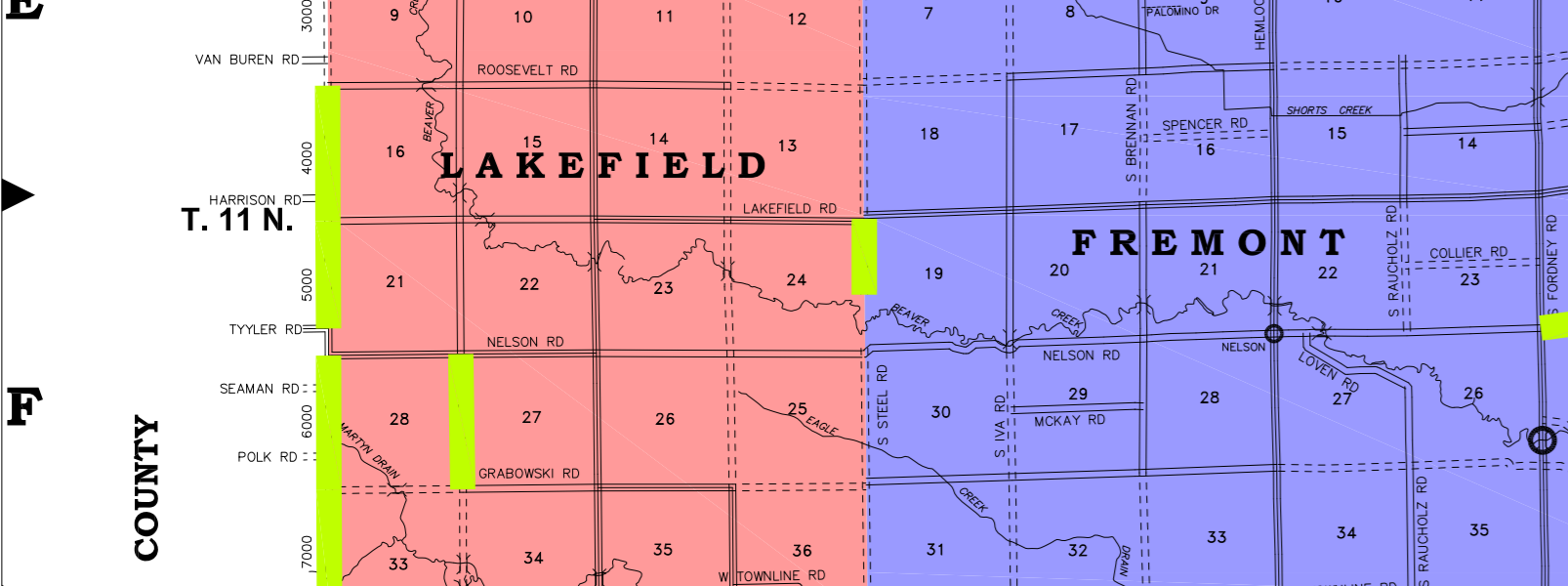
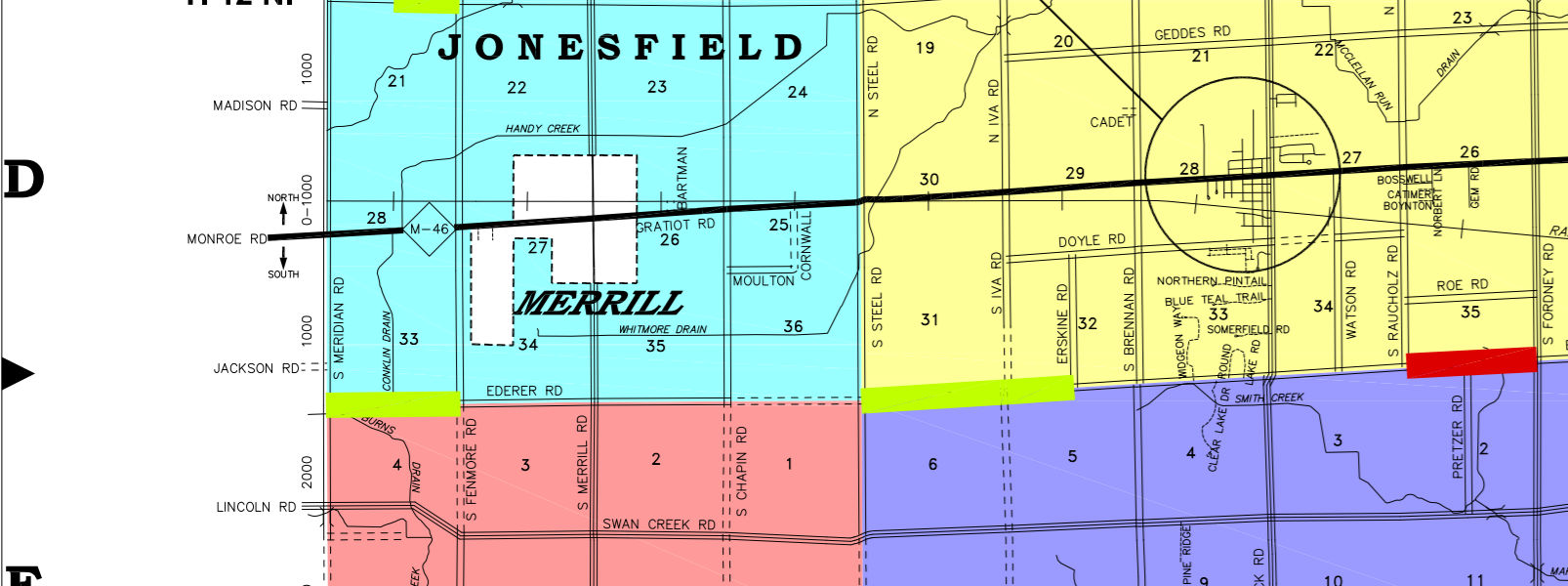
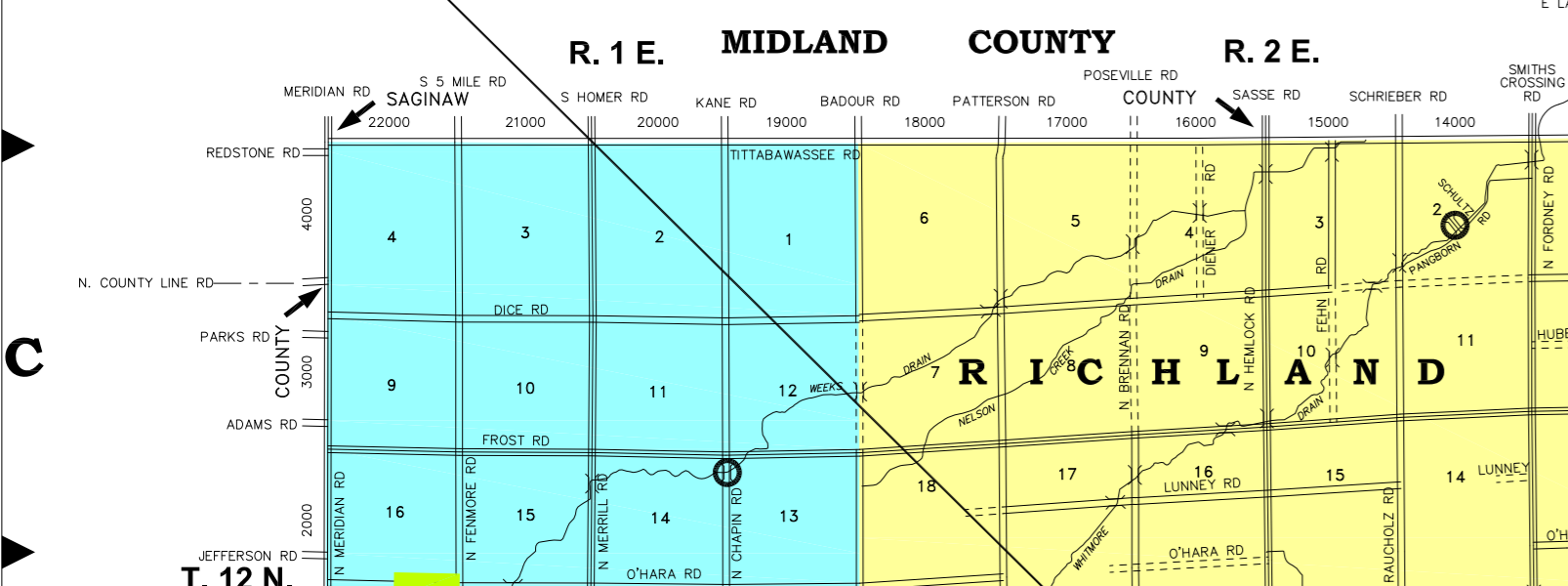
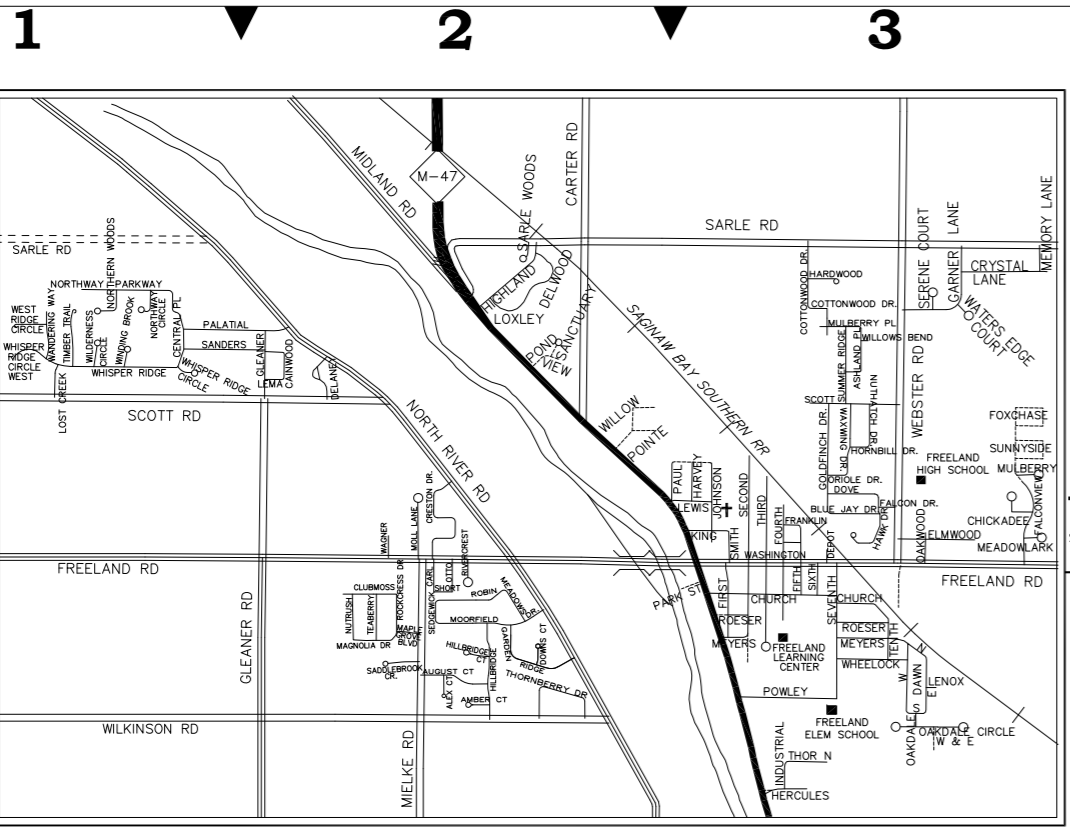
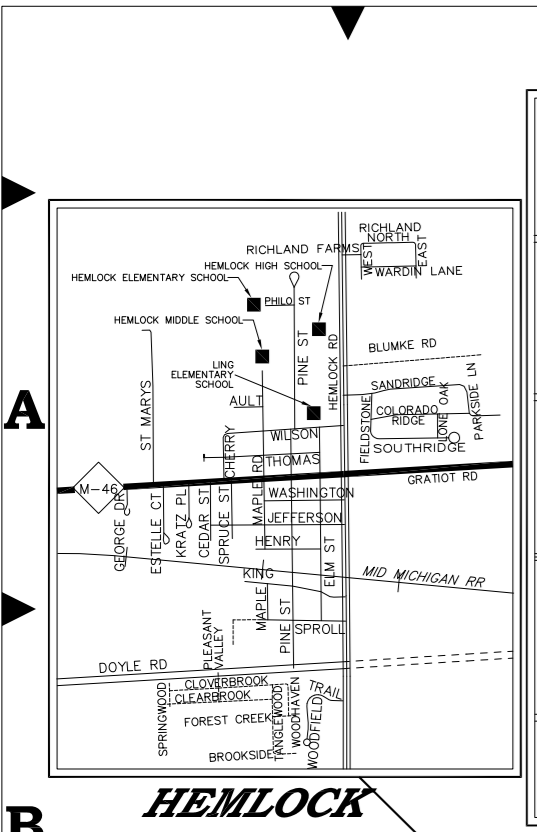
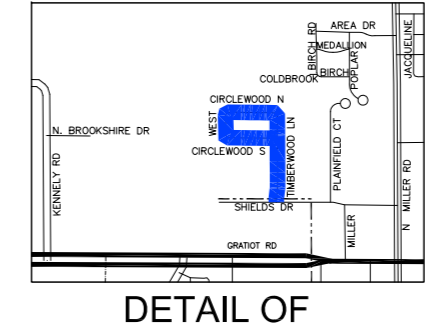

LEGEND

- INTER-STATE HIGHWAYS
- FEDERAL HIGHWAYS
- STATE HIGHWAYS
- COUNTY PRIMARY ROADS
- HARD SURFACE ROADS
- GRAVEL ROADS
- STATE & FEDERAL LAND
- COUNTY PARK
- RESTRICTED BRIDGE
- CLOSED BRIDGE
- URBAN AREA LIMITS

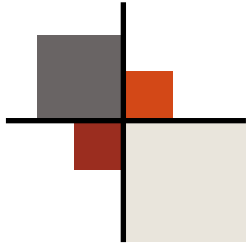

PRIMARY ROAD MAINTENANCE BY TOWNSHIP

DESCRIPTION	ALBEE	BIRCH RUN	BLUMFIELD	BRADY	BRANT	BRIDGEPORT	BUENA VISTA
100 - DUST CONTROL	0.00	0.00	0.00	0.00	0.00	0.00	0.00
104 - SEAL COAT	0.00	0.00	528.43	0.00	0.00	0.00	0.00
104S-SWEEPING - CHIPSEAL	0.00	0.00	161.62	0.00	0.00	518.49	0.00
105 - CRACK SEAL	0.00	0.00	0.00	0.00	0.00	0.00	0.00
109 - SURFACE MAINTENANCE	2,274.30	0.00	0.00	0.00	0.00	910.64	0.00
109A - SURF. MAINT. - ASPHALT	0.00	0.00	0.00	0.00	2,100.00	5,400.00	0.00
109C - SURF. MAINT. - COLD PATCH	6,359.05	11,524.32	0.00	474.44	2,251.69	18,117.22	5,949.40
109G - SURF. MAINT. - GRAVEL	0.00	0.00	0.00	0.00	0.00	601.04	0.00
109H - SURF. MAINT. - HOT PATCH	0.00	0.00	0.00	0.00	0.00	762.46	0.00
109R - SURF. MAINT. - ROAD PATCHER	1,121.33	4,185.62				18,417.37	3,431.36
119 - SHOULDER MAINTENANCE	17,113.98	15,130.41	2,121.52	4,407.48	7,968.86	7,772.25	5,756.51
120 - BRUSH SPRAYING	0.00	0.00	0.00	0.00	0.00	0.00	0.00
121 - TREE & SHRUB REMOVAL	225.39	0.00	0.00	1,932.28	1,386.79	886.70	275.92
122 - DRAINAGE & BACKSLOPE	26,821.01	2,650.14	16,783.50	2,360.86	10,430.39	22,017.56	8,084.07
123 - GUARDRAIL SPRAYING	0.00	0.00	0.00	0.00	0.00	0.00	0.00
124 - ROADSIDE CLEANUP	0.00	0.00	0.00	0.00	0.00	0.00	0.00
125 - SEEDING & MULCHING	395.88	0.00	0.00	455.48	271.94	1,637.20	0.00
126 - GRASS & WEED CONTROL	4,489.35	1,438.00	0.00	2,015.25	3,085.50	4,225.05	719.00
127 - DITCH-SHRUB REMOVAL	0.00	0.00	0.00	0.00	0.00	0.00	279.60
128 - CULVERT MAINTENANCE	0.00	0.00	0.00	0.00	78.92	0.00	971.76
130 - GUARD RAIL POSTS	1,091.92	157.84	1,236.50	0.00	0.00	303.12	2,232.12
132 - SWEEPING	1,293.00	808.12	431.00	0.00	538.75	12,270.54	4,378.87
134 - TRAFFIC CONTROL	389.15	328.72	0.00	0.00	0.00	954.96	1,191.61
139 - OTHER ROUTINE MAINTENANCE	1,386.11	0.00	0.00	674.15	644.48	0.00	138.58
141 - WINTER MAINT. (SNOW & ICE)	29,226.12	38,222.46	19,436.77	20,973.78	23,873.84	38,108.72	52,140.87
149 - OTHER WINTER MAINT.	2,441.72	4,695.22	7,770.30	612.92	1,880.44	1,894.48	11,305.06
151 - BRIDGE MAINTENANCE	0.00	0.00	0.00	0.00	0.00	0.00	0.00
152 - PAINTING BRIDGES	0.00	0.00	0.00	0.00	0.00	0.00	0.00
158 - BRIDGE SLOPE REPAIRS	0.00	0.00	0.00	0.00	0.00	90.00	45.00
159 - OTHER BRIDGE MAINTENANCE	0.00	0.00	0.00	0.00	0.00	0.00	0.00
161 - TRAFFIC SIGNAL MAINTENANCE	0.00	0.00	0.00	0.00	0.00	0.00	0.00
162 - PAVEMENT MARKINGS	0.00	0.00	0.00	0.00	0.00	5,269.85	2,366.26
163 - LINE STRIPING	6,228.91	12,158.66	0.00	0.00	5,269.70	22,326.67	7,775.10
165 - NORMAL SIGN MAINTENANCE	54.73	121.12	274.84	0.00	0.00	671.38	0.00
168 - CONSUMERS ENERGY BILLS	0.00	0.00	0.00	0.00	0.00	0.00	0.00
169 - OTHER SIGN MAINTENANCE	0.00	0.00	0.00	0.00	0.00	0.00	0.00
46600 000 - MISC PRIMARY WORK	0.00	0.00	0.00	0.00	0.00	0.00	0.00
TOTAL PRIMARY MAINTENANCE:	100,911.95	91,420.63	48,744.48	33,906.64	59,781.30	163,155.70	107,041.09



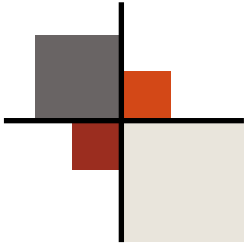

PRIMARY ROAD MAINTENANCE BY TOWNSHIP

DESCRIPTION	CARROLLTON	CHAPIN	CHESANING	FRANKENMUTH	FREMONT	JAMES	JONESFIELD	KOCHVILLE
100 - DUST CONTROL	0.00	0.00	0.00	0.00	0.00	0.00	0.00	0.00
104 - SEAL COAT	4,856.55	0.00	0.00	0.00	0.00	0.00	0.00	4,856.56
104S-SWEEPING - CHIPSEAL	0.00	0.00	3,873.16	0.00	0.00	0.00	0.00	0.00
105 - CRACK SEAL	0.00	0.00	0.00	0.00	0.00	0.00	0.00	0.00
109 - SURFACE MAINTENANCE	0.00	0.00	0.00	0.00	0.00	0.00	0.00	0.00
109A - SURF. MAINT. - ASPHALT	0.00	0.00	0.00	0.00	0.00	0.00	0.00	0.00
109C - SURF. MAINT. - COLD PATCH	7,850.39	383.20	1,681.32	914.24	383.20	191.60	2,666.04	5,291.92
109G - SURF. MAINT. - GRAVEL	0.00	0.00	0.00	0.00	0.00	0.00	0.00	0.00
109H - SURF. MAINT. - HOT PATCH	0.00	0.00	0.00	0.00	0.00	0.00	0.00	0.00
109R - SURF. MAINT. - ROAD PATCHER	1,294.77			2,495.08				1,133.08
119 - SHOULDER MAINTENANCE	4,112.49	4,903.48	6,273.88	9,762.49	9,413.46	926.44	5,807.40	7,238.36
120 - BRUSH SPRAYING	0.00	0.00	0.00	0.00	0.00	0.00	0.00	0.00
121 - TREE & SHRUB REMOVAL	0.00	749.65	2,539.83	66.48	0.00	2,432.82	0.00	0.00
122 - DRAINAGE & BACKSLOPE	9,613.62	0.00	6,749.04	2,637.04	1,726.52	8,999.47	512.25	7,485.27
123 - GUARDRAIL SPRAYING	0.00	0.00	0.00	0.00	0.00	0.00	0.00	0.00
124 - ROADSIDE CLEANUP	0.00	0.00	0.00	0.00	0.00	0.00	0.00	0.00
125 - SEEDING & MULCHING	0.00	0.00	648.50	0.00	0.00	0.00	0.00	806.10
126 - GRASS & WEED CONTROL	3,274.10	1,612.20	3,002.40	2,396.80	3,225.28	820.88	1,339.60	1,359.60
127 - DITCH-SHRUB REMOVAL	0.00	0.00	0.00	349.50	0.00	99.84	0.00	0.00
128 - CULVERT MAINTENANCE	0.00	0.00	0.00	0.00	1,374.12	61.52	0.00	0.00
130 - GUARD RAIL POSTS	0.00	0.00	1,990.00	755.28	0.00	0.00	0.00	1,275.00
132 - SWEEPING	2,586.00	107.75	431.00	0.00	237.39	323.25	215.50	2,262.75
134 - TRAFFIC CONTROL	392.76	0.00	0.00	1,056.24	0.00	96.30	0.00	300.88
139 - OTHER ROUTINE MAINTENANCE	0.00	732.81	846.97	0.00	0.00	0.00	0.00	1,808.56
141 - WINTER MAINT. (SNOW & ICE)	24,246.68	5,156.19	40,118.30	34,612.80	15,550.67	4,600.72	14,400.41	26,451.24
149 - OTHER WINTER MAINT.	601.04	2,616.04	1,241.98	8,894.60	0.00	0.00	0.00	5,367.40
151 - BRIDGE MAINTENANCE	0.00	0.00	0.00	0.00	0.00	0.00	0.00	0.00
152 - PAINTING BRIDGES	0.00	0.00	0.00	0.00	0.00	0.00	0.00	0.00
158 - BRIDGE SLOPE REPAIRS	0.00	0.00	0.00	0.00	0.00	0.00	0.00	0.00
159 - OTHER BRIDGE MAINTENANCE	0.00	0.00	0.00	3,391.20	0.00	0.00	0.00	0.00
161 - TRAFFIC SIGNAL MAINTENANCE	0.00	0.00	0.00	0.00	0.00	0.00	0.00	0.00
162 - PAVEMENT MARKINGS	3,587.54	0.00	0.00	885.50	2,271.50	67.18	229.65	3,283.19
163 - LINE STRIPING	3,422.91	908.70	4,539.74	7,657.03	0.00	914.31	4,469.27	9,706.14
165 - NORMAL SIGN MAINTENANCE	187.48	0.00	0.00	0.00	0.00	3,458.18	0.00	163.32
168 - CONSUMERS ENERGY BILLS	0.00	0.00	0.00	0.00	0.00	0.00	0.00	0.00
169 - OTHER SIGN MAINTENANCE	0.00	0.00	364.13	0.00	0.00	0.00	0.00	0.00
46600 000 - MISC PRIMARY WORK	0.00	0.00	0.00	0.00	0.00	0.00	0.00	0.00
TOTAL PRIMARY MAINTENANCE:	66,026.33	17,170.02	74,300.25	75,874.28	34,182.14	22,992.51	29,640.12	78,789.37



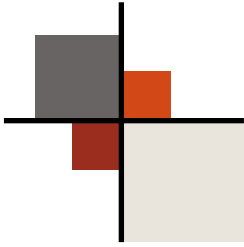

PRIMARY ROAD MAINTENANCE BY TOWNSHIP

DESCRIPTION	LAKEFIELD	MAPLE GROVE	MARION	RICHLAND	SAGINAW	ST. CHARLES	SPAULDING
100 - DUST CONTROL	0.00	0.00	0.00	0.00	0.00	0.00	0.00
104 - SEAL COAT	0.00	0.00	0.00	0.00	0.00	0.00	377.45
104S-SWEEPING - CHIPSEAL	0.00	0.00	0.00	0.00	1,024.02	0.00	0.00
105 - CRACK SEAL	0.00	0.00	0.00	0.00	0.00	0.00	0.00
109 - SURFACE MAINTENANCE	0.00	0.00	0.00	59.28	1,668.20	0.00	0.00
109A - SURF. MAINT. - ASPHALT	0.00	0.00	0.00	5,165.00	4,629.80	0.00	0.00
109C - SURF. MAINT. - COLD PATCH	563.44	4,096.58	1,559.02	1,472.54	33,725.16	279.16	0.00
109G - SURF. MAINT. - GRAVEL	0.00	0.00	0.00	0.00	566.24	0.00	0.00
109H - SURF. MAINT. - HOT PATCH	0.00	0.00	0.00	0.00	0.00	0.00	0.00
109R - SURF. MAINT. - ROAD PATCHER	481.90		1,060.18		3,115.38	235.55	
119 - SHOULDER MAINTENANCE	2,161.10	11,806.81	1,957.80	6,421.69	9,562.14	5,478.94	2,292.54
120 - BRUSH SPRAYING	0.00	0.00	0.00	0.00	0.00	0.00	0.00
121 - TREE & SHRUB REMOVAL	0.00	0.00	0.00	9,410.90	5,490.32	749.65	460.00
122 - DRAINAGE & BACKSLOPE	274.56	5,198.51	9,771.30	894.05	26,911.31	6,779.95	6,437.42
123 - GUARDRAIL SPRAYING	0.00	0.00	0.00	0.00	0.00	0.00	0.00
124 - ROADSIDE CLEANUP	0.00	0.00	0.00	0.00	0.00	0.00	0.00
125 - SEEDING & MULCHING	0.00	308.40	0.00	0.00	0.00	0.00	0.00
126 - GRASS & WEED CONTROL	4,018.80	2,477.20	2,337.69	4,329.32	3,496.06	2,072.85	2,157.00
127 - DITCH-SHRUB REMOVAL	0.00	0.00	0.00	0.00	0.00	0.00	0.00
128 - CULVERT MAINTENANCE	0.00	0.00	0.00	2,321.12	0.00	0.00	0.00
130 - GUARD RAIL POSTS	0.00	3,181.93	0.00	0.00	601.04	2,282.50	0.00
132 - SWEEPING	538.74	1,113.05	161.62	431.00	23,438.38	431.00	969.75
134 - TRAFFIC CONTROL	0.00	420.80	0.00	327.28	1,775.39	0.00	0.00
139 - OTHER ROUTINE MAINTENANCE	0.00	856.55	866.31	0.00	1,550.96	928.76	0.00
141 - WINTER MAINT. (SNOW & ICE)	21,336.56	28,791.34	14,486.96	21,346.23	118,219.72	23,773.08	21,177.54
149 - OTHER WINTER MAINT.	0.00	1,780.80	1,468.50	322.52	5,606.34	1,947.63	522.64
151 - BRIDGE MAINTENANCE	0.00	0.00	0.00	0.00	0.00	0.00	0.00
152 - PAINTING BRIDGES	0.00	0.00	0.00	0.00	0.00	0.00	0.00
158 - BRIDGE SLOPE REPAIRS	0.00	0.00	0.00	0.00	0.00	0.00	0.00
159 - OTHER BRIDGE MAINTENANCE	0.00	0.00	0.00	0.00	0.00	0.00	0.00
161 - TRAFFIC SIGNAL MAINTENANCE	0.00	0.00	0.00	0.00	1,916.86	0.00	67.36
162 - PAVEMENT MARKINGS	0.00	0.00	87.30	1,062.32	14,831.55	0.00	27.65
163 - LINE STRIPING	3,302.43	5,857.29	4,922.26	3,123.83	10,344.77	427.75	0.00
165 - NORMAL SIGN MAINTENANCE	34.48	0.00	0.00	4,793.48	1,246.73	50.06	0.00
168 - CONSUMERS ENERGY BILLS	0.00	0.00	0.00	0.00	0.00	0.00	0.00
169 - OTHER SIGN MAINTENANCE	0.00	0.00	0.00	252.80	189.60	0.00	0.00
46600 000 - MISC PRIMARY WORK	0.00	0.00	0.00	0.00	0.00	0.00	0.00
TOTAL PRIMARY MAINTENANCE:	32,712.01	65,889.26	38,678.94	61,733.36	269,909.97	45,436.88	34,489.35



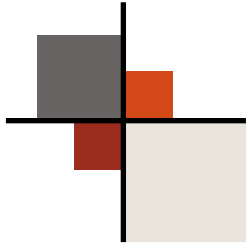

PRIMARY ROAD MAINTENANCE BY TOWNSHIP

DESCRIPTION	SWAN CREEK	TAYMOUTH	THOMAS	TITTABAWASSEE	ZILWAUKEE	ALL TOWNSHIPS
100 - DUST CONTROL	0.00	0.00	0.00	0.00	0.00	0.00
104 - SEAL COAT	0.00	0.00	0.00	0.00	0.00	10,618.99
104S-SWEEPING - CHIPSEAL	0.00	0.00	0.00	0.00	0.00	5,577.29
105 - CRACK SEAL	0.00	375.00	0.00	0.00	0.00	375.00
109 - SURFACE MAINTENANCE	0.00	0.00	704.96	3,640.96	0.00	9,258.34
109A - SURF. MAINT. - ASPHALT	4,800.00	0.00	1,374.35	0.00	0.00	23,469.15
109C - SURF. MAINT. - COLD PATCH	391.56	1,084.16	2,731.15	11,093.12	0.00	121,033.92
109G - SURF. MAINT. - GRAVEL	0.00	0.00	0.00	0.00	0.00	1,167.28
109H - SURF. MAINT. - HOT PATCH	0.00	0.00	0.00	0.00	0.00	762.46
109R - SURF. MAINT. - ROAD PATCHER				2,656.51		39,628.13
119 - SHOULDER MAINTENANCE	3,003.63	12,782.91	9,034.00	17,779.74	568.00	191,558.31
120 - BRUSH SPRAYING	0.00	0.00	0.00	0.00	0.00	0.00
121 - TREE & SHRUB REMOVAL	614.92	1,217.84	1,988.18	0.00	0.00	30,427.67
122 - DRAINAGE & BACKSLOPE	19.73	1,253.91	8,548.13	18,134.13	715.43	211,809.17
123 - GUARDRAIL SPRAYING	0.00	0.00	0.00	0.00	0.00	0.00
124 - ROADSIDE CLEANUP	0.00	0.00	0.00	0.00	0.00	0.00
125 - SEEDING & MULCHING	0.00	0.00	0.00	366.28	0.00	4,889.78
126 - GRASS & WEED CONTROL	0.00	7,909.00	3,491.15	5,438.40	0.00	70,730.48
127 - DITCH-SHRUB REMOVAL	0.00	0.00	481.74	0.00	0.00	1,210.68
128 - CULVERT MAINTENANCE	0.00	0.00	1,181.77	1,035.64	0.00	7,024.85
130 - GUARD RAIL POSTS	0.00	5,189.55	3,529.44	0.00	0.00	23,826.24
132 - SWEEPING	53.88	1,293.00	592.63	2,439.52	107.75	57,454.24
134 - TRAFFIC CONTROL	327.28	1,966.75	6,429.31	0.00	0.00	15,957.43
139 - OTHER ROUTINE MAINTENANCE	0.00	0.00	0.00	3,663.20	0.00	14,097.44
141 - WINTER MAINT. (SNOW & ICE)	7,835.58	56,568.88	18,514.26	57,081.39	0.00	776,251.11
149 - OTHER WINTER MAINT.	0.00	8,786.22	0.00	10,216.84	0.00	79,972.69
151 - BRIDGE MAINTENANCE	0.00	0.00	1,800.00	0.00	0.00	1,800.00
152 - PAINTING BRIDGES	0.00	0.00	0.00	0.00	0.00	0.00
158 - BRIDGE SLOPE REPAIRS	0.00	90.00	0.00	0.00	0.00	225.00
159 - OTHER BRIDGE MAINTENANCE	0.00	0.00	0.00	0.00	0.00	3,391.20
161 - TRAFFIC SIGNAL MAINTENANCE	0.00	0.00	63.20	426.40	0.00	2,473.82
162 - PAVEMENT MARKINGS	273.18	1,142.56	1,335.82	2,017.24	323.77	39,062.06
163 - LINE STRIPING	0.00	9,765.51	5,158.00	12,919.27	545.34	141,743.59
165 - NORMAL SIGN MAINTENANCE	0.00	0.00	177.68	0.00	0.00	11,233.48
168 - CONSUMERS ENERGY BILLS	0.00	0.00	0.00	0.00	0.00	0.00
169 - OTHER SIGN MAINTENANCE	0.00	0.00	0.00	0.00	0.00	806.53
46600 000 - MISC PRIMARY WORK	0.00	0.00	0.00	0.00	0.00	0.00
TOTAL PRIMARY MAINTENANCE:	17,319.76	109,425.29	67,135.77	148,908.64	2,260.29	1,897,836.33



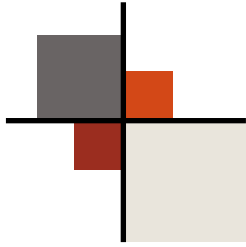

LOCAL ROAD MAINTENANCE BY TOWNSHIP

DESCRIPTION	ALBEE	BIRCH RUN	BLUMFIELD	BRADY	BRANT	BRIDGEPORT	BUENA VISTA
100 - DUST CONTROL	6,618.37	450.53	3,399.82	7,030.45	1,125.22	1,818.43	1,252.11
104 - SEAL COAT	0.00	3,853.70	123,876.87	18,918.48	0.00	13,297.89	(262.66)
104S-SWEEPING - CHIPSEAL	0.00	3,496.22	5,592.09	1,564.21	0.00	1,337.34	2,653.95
105 - CRACK SEAL	0.00	137.36	244.37	0.00	0.00	0.00	0.00
109 - SURFACE MAINTENANCE	0.00	40,726.52	0.00	6,786.11	1,368.84	6,037.90	421.75
109A - SURF. MAINT. - ASPHALT	0.00	0.00	3,960.00	0.00	0.00	152.73	0.00
109C - SURF. MAINT. - COLD PATCH	9,829.98	32,302.26	1,383.96	22,991.16	2,300.04	22,336.34	38,956.75
109G - SURF. MAINT. - GRAVEL	11,089.15	6,746.48	5,183.46	22,588.16	45,599.97	6,684.78	21,617.04
109H - SURF. MAINT. - HOT PATCH	0.00	7,074.65	27,650.26	5,112.15	0.00	9,410.54	21,922.39
109R - SURF. MAINT. - ROAD PATCHER	1,273.12	2,460.31	912.21	3,059.32	867.26	3,009.47	515.37
119 - SHOULDER MAINTENANCE	0.00	420.65	0.00	993.92	589.50	814.10	0.00
120 - BRUSH SPRAYING	0.00	0.00	0.00	0.00	0.00	0.00	0.00
121 - TREE & SHRUB REMOVAL	4,394.80	0.00	2,816.18	7,665.68	23,322.89	2,717.40	10,857.72
122 - DRAINAGE & BACKSLOPE	3,922.72	29,062.96	11,331.96	15,908.43	40,728.28	19,303.47	10,412.74
123 - GUARDRAIL SPRAYING	0.00	0.00	0.00	0.00	0.00	0.00	0.00
124 - ROADSIDE CLEANUP	0.00	0.00	0.00	0.00	0.00	0.00	0.00
125 - SEEDING & MULCHING	0.00	0.00	0.00	277.74	2,861.98	814.20	0.00
126 - GRASS & WEED CONTROL	3,002.40	4,168.00	3,595.00	5,078.43	6,118.47	596.60	5,518.40
127 - DITCH-SHRUB REMOVAL	0.00	0.00	0.00	0.00	0.00	0.00	2,763.60
128 - CULVERT MAINTENANCE	78.92	0.00	0.00	0.00	0.00	0.00	22,147.48
130 - GUARD RAIL POSTS	0.00	0.00	0.00	0.00	0.00	0.00	3,465.48
132 - SWEEPING	767.50	1,329.59	215.50	377.12	323.25	8,081.26	2,903.13
134 - TRAFFIC CONTROL	492.76	193.82	514.20	585.55	191.02	0.00	250.30
139 - OTHER ROUTINE MAINTENANCE	0.00	0.00	0.00	0.00	0.00	0.00	602.40
141 - WINTER MAINT. (SNOW & ICE)	23,427.70	40,773.98	34,328.34	15,292.54	28,007.16	28,914.26	29,289.78
149 - OTHER WINTER MAINT.	0.00	0.00	745.52	0.00	0.00	0.00	0.00
151 - BRIDGE MAINTENANCE	0.00	0.00	0.00	0.00	0.00	0.00	0.00
152 - PAINTING BRIDGES	0.00	0.00	0.00	0.00	0.00	0.00	0.00
158 - BRIDGE SLOPE REPAIRS	0.00	0.00	0.00	0.00	0.00	0.00	0.00
159 - OTHER BRIDGE MAINTENANCE	0.00	0.00	0.00	0.00	0.00	0.00	0.00
161 - TRAFFIC SIGNAL MAINTENANCE	0.00	0.00	0.00	0.00	0.00	0.00	0.00
162 - PAVEMENT MARKINGS	0.00	657.91	2,139.26	235.03	0.00	2,802.22	1,637.46
163 - LINE STRIPING	0.00	0.00	87.61	0.00	0.00	117.08	0.00
165 - NORMAL SIGN MAINTENANCE	219.07	250.74	656.19	112.02	0.00	163.70	480.93
168 - CONSUMERS ENERGY BILLS	0.00	0.00	0.00	0.00	0.00	0.00	0.00
169 - OTHER SIGN MAINTENANCE	0.00	63.20	0.00	274.84	0.00	453.80	0.00
46600 000 - MISC PRIMARY WORK	0.00	0.00	0.00	0.00	0.00	0.00	0.00
TOTAL LOCAL MAINT.	65,116.49	174,168.88	228,632.80	134,851.34	153,403.88	128,863.51	177,406.12



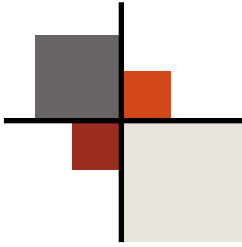

LOCAL ROAD MAINTENANCE BY TOWNSHIP

DESCRIPTION	CARROLLTON	CHAPIN	CHESANING	FRANKENMUTH	FREMONT	JAMES	JONESFIELD	KOCHVILLE
100 - DUST CONTROL	847.17	7,588.09	1,594.74	3,308.59	10,011.10	534.64	1,146.14	291.77
104 - SEAL COAT	28,884.64	0.00	56,330.55	22,902.98	0.00	0.00	0.00	40,154.09
104S-SWEEPING - CHIPSEAL	8,045.02	0.00	1,921.85	1,863.60	538.75	0.00	0.00	4,380.20
105 - CRACK SEAL	0.00	0.00	0.00	0.00	0.00	0.00	0.00	0.00
109 - SURFACE MAINTENANCE	2,367.30	847.35	0.00	1,518.70	3,169.80	998.30	12,087.05	0.00
109A - SURF. MAINT. - ASPHALT	1,147.12	0.00	2,500.00	0.00	0.00	0.00	0.00	0.00
109C - SURF. MAINT. - COLD PATCH	13,708.26	4,532.28	2,481.11	14,243.92	7,320.05	9,277.16	19,341.72	6,615.72
109G - SURF. MAINT. - GRAVEL	2,329.38	23,446.57	2,512.44	9,586.31	17,707.96	1,046.00	1,980.04	2,995.02
109H - SURF. MAINT. - HOT PATCH	0.00	10,603.41	0.00	14,826.16	676.17	0.00	0.00	1,283.40
109R - SURF. MAINT. - ROAD PATCHER	430.47			1,118.61	192.76	1,231.34	192.67	96.38
119 - SHOULDER MAINTENANCE	383.20	1,023.22	872.04	2,270.50	588.39	635.97	96.30	898.20
120 - BRUSH SPRAYING	0.00	0.00	0.00	0.00	0.00	0.00	0.00	0.00
121 - TREE & SHRUB REMOVAL	1,350.00	543.54	966.00	1,500.00	989.50	2,436.10	8,793.81	20.62
122 - DRAINAGE & BACKSLOPE	7,015.38	9,382.58	21,132.74	6,366.03	11,841.46	5,725.53	9,685.62	10,023.36
123 - GUARDRAIL SPRAYING	0.00	0.00	0.00	0.00	0.00	0.00	0.00	0.00
124 - ROADSIDE CLEANUP	0.00	0.00	0.00	0.00	0.00	0.00	0.00	0.00
125 - SEEDING & MULCHING	314.02	1,211.70	3,844.03	0.00	862.74	0.00	0.00	0.00
126 - GRASS & WEED CONTROL	689.80	4,514.16	1,737.45	4,966.44	1,339.60	669.80	3,354.97	806.10
127 - DITCH-SHRUB REMOVAL	0.00	0.00	0.00	0.00	0.00	0.00	0.00	279.60
128 - CULVERT MAINTENANCE	0.00	0.00	0.00	0.00	937.65	0.00	0.00	0.00
130 - GUARD RAIL POSTS	0.00	0.00	448.56	0.00	0.00	855.00	0.00	0.00
132 - SWEEPING	1,777.87	107.75	0.00	323.25	745.27	0.00	0.00	862.00
134 - TRAFFIC CONTROL	0.00	277.14	139.38	1,584.03	0.00	636.57	0.00	0.00
139 - OTHER ROUTINE MAINTENANCE	0.00	0.00	0.00	1,027.20	0.00	0.00	0.00	2,076.98
141 - WINTER MAINT. (SNOW & ICE)	12,191.54	20,620.35	14,719.92	39,330.71	35,300.42	12,123.36	30,162.88	14,847.66
149 - OTHER WINTER MAINT.	0.00	0.00	0.00	34.94	0.00	0.00	0.00	74.99
151 - BRIDGE MAINTENANCE	0.00	0.00	0.00	0.00	0.00	0.00	0.00	0.00
152 - PAINTING BRIDGES	0.00	0.00	0.00	0.00	0.00	0.00	0.00	0.00
158 - BRIDGE SLOPE REPAIRS	0.00	0.00	0.00	0.00	0.00	0.00	0.00	0.00
159 - OTHER BRIDGE MAINTENANCE	0.00	0.00	0.00	0.00	0.00	0.00	0.00	0.00
161 - TRAFFIC SIGNAL MAINTENANCE	0.00	0.00	0.00	0.00	0.00	0.00	0.00	0.00
162 - PAVEMENT MARKINGS	2,549.32	0.00	1,111.31	795.95	0.00	336.71	445.92	2,495.37
163 - LINE STRIPING	213.21	0.00	1,054.01	155.43	0.00	55.77	163.61	1,541.64
165 - NORMAL SIGN MAINTENANCE	195.49	137.42	547.64	342.44	0.00	2,300.14	0.00	121.74
168 - CONSUMERS ENERGY BILLS	0.00	0.00	0.00	0.00	0.00	0.00	0.00	0.00
169 - OTHER SIGN MAINTENANCE	0.00	0.00	101.36	0.00	0.00	206.90	0.00	0.00
46600 000 - MISC PRIMARY WORK	0.00	0.00	0.00	0.00	0.00	0.00	0.00	0.00
TOTAL LOCAL MAINT.	84,439.19	84,835.56	114,015.13	128,065.79	92,221.62	39,069.29	87,450.73	89,864.84



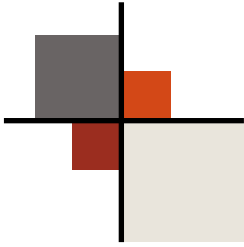

LOCAL ROAD MAINTENANCE BY TOWNSHIP

DESCRIPTION	LAKEFIELD	MAPLE GROVE	MARION	RICHLAND	SAGINAW	ST. CHARLES	SPAULDING
100 - DUST CONTROL	9,186.42	2,086.83	7,927.78	7,612.52	0.00	4,139.09	2,683.01
104 - SEAL COAT	0.00	48,771.19	35,864.93	751.30	0.00	0.00	0.00
104S-SWEEPING - CHIPSEAL	0.00	5,358.35	5,477.07	963.26	11,574.97	0.00	0.00
105 - CRACK SEAL	0.00	0.00	0.00	0.00	0.00	0.00	0.00
109 - SURFACE MAINTENANCE	1,387.95	438.60	0.00	8,979.44	8,506.00	1,645.84	75.62
109A - SURF. MAINT. - ASPHALT	0.00	0.00	0.00	1,100.00	5,083.80	0.00	932.50
109C - SURF. MAINT. - COLD PATCH	9,203.11	10,321.76	461.88	21,861.99	32,232.70	3,470.26	4,990.79
109G - SURF. MAINT. - GRAVEL	20,263.28	2,843.64	21,787.72	20,070.76	0.00	24,789.96	10,637.69
109H - SURF. MAINT. - HOT PATCH	0.00	10,559.06	0.00	9,598.65	5,516.06	0.00	23,240.18
109R - SURF. MAINT. - ROAD PATCHER		583.76	144.57	1,137.59	674.66	235.55	192.76
119 - SHOULDER MAINTENANCE	962.80	2,156.52	0.00	0.00	2,857.10	684.48	1,214.96
120 - BRUSH SPRAYING	0.00	0.00	0.00	0.00	0.00	0.00	0.00
121 - TREE & SHRUB REMOVAL	1,830.72	9,973.35	7,564.50	3,761.57	5,264.69	1,238.13	0.00
122 - DRAINAGE & BACKSLOPE	12,164.53	28,858.26	18,902.39	12,580.53	17,782.74	7,363.52	33,265.41
123 - GUARDRAIL SPRAYING	0.00	0.00	0.00	0.00	0.00	0.00	0.00
124 - ROADSIDE CLEANUP	0.00	0.00	0.00	0.00	0.00	0.00	0.00
125 - SEEDING & MULCHING	333.90	2,245.28	1,037.44	387.06	761.00	631.53	747.50
126 - GRASS & WEED CONTROL	3,349.00	3,803.04	1,531.59	6,443.60	2,069.40	5,330.49	689.80
127 - DITCH-SHRUB REMOVAL	1,962.95	0.00	0.00	0.00	2,752.80	0.00	174.75
128 - CULVERT MAINTENANCE	3,059.83	0.00	0.00	1,126.60	2,001.70	0.00	669.51
130 - GUARD RAIL POSTS	0.00	0.00	0.00	1,991.00	0.00	0.00	0.00
132 - SWEEPING	1,353.13	646.50	700.37	2,801.51	34,329.14	484.87	700.38
134 - TRAFFIC CONTROL	1,132.18	0.00	0.00	0.00	475.37	0.00	0.00
139 - OTHER ROUTINE MAINTENANCE	0.00	0.00	0.00	0.00	2,052.24	0.00	0.00
141 - WINTER MAINT. (SNOW & ICE)	38,560.19	20,799.83	18,241.36	38,162.51	85,442.80	23,479.66	11,446.09
149 - OTHER WINTER MAINT.	0.00	0.00	0.00	2,126.31	0.00	0.00	0.00
151 - BRIDGE MAINTENANCE	0.00	0.00	0.00	0.00	0.00	0.00	0.00
152 - PAINTING BRIDGES	0.00	0.00	0.00	0.00	0.00	0.00	0.00
158 - BRIDGE SLOPE REPAIRS	0.00	0.00	0.00	0.00	0.00	0.00	767.40
159 - OTHER BRIDGE MAINTENANCE	0.00	0.00	0.00	0.00	0.00	0.00	0.00
161 - TRAFFIC SIGNAL MAINTENANCE	0.00	0.00	0.00	0.00	897.88	0.00	0.00
162 - PAVEMENT MARKINGS	0.00	0.00	0.00	2,103.98	2,811.87	577.18	92.81
163 - LINE STRIPING	0.00	462.03	0.00	296.80	138.25	163.53	0.00
165 - NORMAL SIGN MAINTENANCE	113.02	137.42	77.91	9,760.47	352.17	0.00	0.00
168 - CONSUMERS ENERGY BILLS	0.00	0.00	0.00	0.00	0.00	0.00	0.00
169 - OTHER SIGN MAINTENANCE	0.00	0.00	0.00	63.20	0.00	0.00	0.00
46600 000 - MISC PRIMARY WORK	0.00	0.00	0.00	0.00	0.00	0.00	0.00
TOTAL LOCAL MAINT.	104,863.01	150,045.42	119,719.51	153,680.65	223,577.34	74,234.09	92,521.16



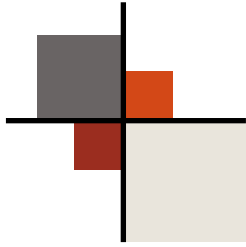

LOCAL ROAD MAINTENANCE BY TOWNSHIP

DESCRIPTION	SWAN CREEK	TAYMOUTH	THOMAS	TITTABAWASSEE	ZILWAUKEE	ALL TOWNSHIPS
100 - DUST CONTROL	1,408.13	5,275.60	1,712.21	1,782.47	0.00	90,831.23
104 - SEAL COAT	0.00	6,291.92	0.00	45,626.08	0.00	445,261.96
104S-SWEEPING - CHIPSEAL	0.00	1,508.50	215.50	7,865.10	0.00	64,355.98
105 - CRACK SEAL	0.00	0.00	0.00	0.00	0.00	381.73
109 - SURFACE MAINTENANCE	0.00	4,341.45	12,201.57	33,245.35	0.00	147,151.44
109A - SURF. MAINT. - ASPHALT	0.00	0.00	0.00	479.00	0.00	15,355.15
109C - SURF. MAINT. - COLD PATCH	2,684.64	23,330.06	21,734.14	17,798.01	0.00	355,710.05
109G - SURF. MAINT. - GRAVEL	7,973.92	23,773.63	889.72	11,634.17	0.00	325,777.25
109H - SURF. MAINT. - HOT PATCH	0.00	18,615.87	0.00	840.48	0.00	166,929.43
109R - SURF. MAINT. - ROAD PATCHER		3,035.49				21,363.67
119 - SHOULDER MAINTENANCE	813.90	342.15	1,611.61	3,437.28	0.00	23,666.79
120 - BRUSH SPRAYING	0.00	0.00	0.00	0.00	0.00	0.00
121 - TREE & SHRUB REMOVAL	1,897.12	32,126.32	4,028.40	45,245.23	0.00	181,304.27
122 - DRAINAGE & BACKSLOPE	6,289.95	14,291.84	26,202.06	11,479.47	0.00	401,023.96
123 - GUARDRAIL SPRAYING	0.00	0.00	0.00	0.00	0.00	0.00
124 - ROADSIDE CLEANUP	0.00	0.00	0.00	0.00	0.00	0.00
125 - SEEDING & MULCHING	532.25	246.44	2,054.95	2,985.37	0.00	22,149.13
126 - GRASS & WEED CONTROL	3,147.90	3,595.00	1,674.50	0.00	0.00	77,789.94
127 - DITCH-SHRUB REMOVAL	0.00	174.75	602.72	206.46	0.00	8,917.63
128 - CULVERT MAINTENANCE	576.82	0.00	25,477.20	0.00	0.00	56,075.71
130 - GUARD RAIL POSTS	0.00	1,240.62	0.00	0.00	0.00	8,000.66
132 - SWEEPING	53.88	592.62	1,723.98	6,034.00	0.00	67,233.87
134 - TRAFFIC CONTROL	0.00	85.96	609.95	933.49	0.00	8,101.72
139 - OTHER ROUTINE MAINTENANCE	0.00	654.40	0.00	1,382.40	0.00	7,795.62
141 - WINTER MAINT. (SNOW & ICE)	14,353.28	38,498.84	29,741.99	36,966.17	0.00	735,023.32
149 - OTHER WINTER MAINT.	0.00	0.00	0.00	374.64	0.00	3,356.40
151 - BRIDGE MAINTENANCE	0.00	0.00	3,938.00	0.00	0.00	3,938.00
152 - PAINTING BRIDGES	0.00	0.00	0.00	0.00	0.00	0.00
158 - BRIDGE SLOPE REPAIRS	0.00	1,209.00	0.00	0.00	0.00	1,976.40
159 - OTHER BRIDGE MAINTENANCE	0.00	0.00	0.00	0.00	0.00	0.00
161 - TRAFFIC SIGNAL MAINTENANCE	0.00	0.00	0.00	208.08	0.00	1,105.96
162 - PAVEMENT MARKINGS	0.00	1,146.54	1,321.67	2,546.87	0.00	25,807.38
163 - LINE STRIPING	0.00	0.00	432.45	386.79	0.00	5,268.21
165 - NORMAL SIGN MAINTENANCE	0.00	329.30	258.45	1,483.87	0.00	18,040.13
168 - CONSUMERS ENERGY BILLS	0.00	0.00	0.00	0.00	0.00	0.00
169 - OTHER SIGN MAINTENANCE	0.00	0.00	0.00	63.20	0.00	1,226.50
46600 000 - MISC PRIMARY WORK	0.00	0.00	0.00	0.00	0.00	0.00
TOTAL LOCAL MAINT.	39,731.79	180,706.30	136,431.07	233,003.98	0.00	3,290,919.49



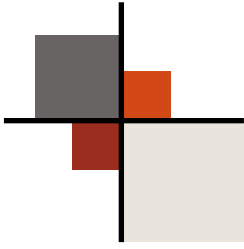

Miscellaneous Maintenance Projects

Township	Road Name	Road Length	From Location	To Location	Project Type	Account Number	Sub Account	Amount (Not incl. Dist.)
Albee	Bueche	1.5	Fry	South to pavement	Maintenance Limestone	496G0110	261	\$ 22,514.18
Albee	Cresswell	0.5	Verne	Fergus	Maintenance Limestone	496G0121	231	\$ 8,050.20
Albee	Verne Road	1	Bueche Road	Cresswell Road	Maintenance Limestone	496G0122	051	\$ 14,980.70
Brady	Baldwin	0.1	Fordney	Hemlock	Maintenance Limestone	496G0402	111	\$ 1,702.45
Brant	Fordney Road	1.66	Schroeder Road	Dempsey Road	Maintenance Limestone	496G0501	351	\$ 24,302.86
Brant	Hanchett	1.02	Fordney	Oakley	Maintenance Limestone	496G0512	161	\$ 16,274.94
Brant	Marion	2.02	Oakley	Raucholz	Maintenance Limestone	496G0523	081	\$ 33,022.68
Brant	Raucholz	1	Burt	Marion	Maintenance Limestone	496G0527	311	\$ 17,172.78
Brant	Burt	2.99	Hemlock	Steel	Maintenance Limestone	496G0529	031	\$ 50,294.67
Chapin	Various Roads	0.1	Various	Various	Maintenance Limestone	496G0900	0	\$ 8,843.66
Chapin	Baldwin	0.75	Merrill Rd	Chapin Rd	Maintenance Limestone	496G0911	131	\$ 13,348.23
Fremont	Nelson	1	Fordney	Orr	Maintenance Limestone	496G1225	121	\$ 15,439.31
Jonesfield	O'Hara	0.5	Fenmore	Meridian	Maintenance Limestone	496G1416	052	\$ 8,633.94
Lakefield	Ederer Road	1	Meridian	Fenmore	Maintenance Limestone	496G1604	011	\$ 16,982.40
Lakefield	Meridian	4.71	Roosevelt	Washington Road	Maintenance Limestone	496G1616	093	\$ 76,013.46
Fremont	Steel	0.61	Lakefield	Dead End	Maintenance Limestone	496G1624	231	\$ 10,619.42
Lakefield	Fenmore	1.01	Nelson	Grabowski	Maintenance Limestone	496G1628	101	\$ 16,405.56
Marion	Chapin	0.54	Colvin	Township Line	Maintenance Limestone	496G1802	151	\$ 9,573.88
Marion	Fenmore	1.5	Brant Road	North to Pavement	Maintenance Limestone	496G1816	131	\$ 24,399.79
Richland	Ederer Road	1.69	Erskine	Steel	Maintenance Limestone	496G1931	011	\$ 26,063.76
St. Charles	Hulien Road	1.01	Village Limits	East to Dead End	Maintenance Limestone	496G2109	241	\$ 16,331.47
St. Charles	Brant	0.74	Oakley	M-52	Maintenance Limestone	496G2118	181	\$ 12,322.34
St. Charles	Niblok	0.47	McKeighan	Frandsche	Maintenance Limestone	496G2132	051	\$ 8,620.67
St. Charles	Larner Road	0.62	Gary Road	North to Dead End	Maintenance Limestone	496G2134	371	\$ 11,456.09
Swan Creek	Orr	2.47	Roosevelt	Prior	Maintenance Limestone	496G2319	221	\$ 46,443.27
Taymouth	Elms Road	0.5	Canada Rd	to North (to RR Tracks)	Maintenance Limestone	496G2413	441	\$ 13,236.43
Thomas	Evans	0.5	S. Thomas	Dead End	Maintenance Limestone	496G2528	091	\$ 9,725.28
Carrrollton	Various Roads	0.1	Entire Township	Entire Township	Concrete Patching	49600800	0	\$ 26,753.13
Saginaw	Various Roads	0.1	Entire Township	Entire Township	Concrete Patching	49602000	0	\$ 66,317.96
Kochville	N. Michigan	1	Pierce	Freeland	Crack Sealing	496S1524	261	\$ 6,519.66
Kochville	Kochville Road	1	Mackinaw Road	Bay (M-84)	Crack Sealing	496S1534	031	\$ 3,141.46
Maple Grove	Chesaning	3	Lincoln	M-13	Crack Sealing	496S1702	151	\$ 21,471.52
Maple Grove	Briggs	1	Volkmer	M-57	Crack Sealing	496S1710	251	\$ 3,761.24
Saginaw	Mill Pond/Logmark	0.28	Hackett	Hackett	Crack Sealing	496S2011	0	\$ 2,085.44
Saginaw	Hackett	0.75	M-47	McCarty	Crack Sealing	496S2012	221	\$ 1,843.38
Saginaw	Riser Subdivision	0.1	Riser Sub	Riser Sub	Crack Sealing	496S2028	231	\$ 3,838.38



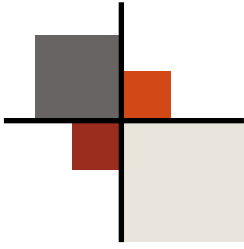

Miscellaneous Maintenance Projects

Township	Road Name	Road Length	From Location	To Location	Project Type	Account Number	Sub Account	Amount (Not incl. Dist.)
Thomas	Various Roads	0.1	Various	Various	Crack Sealing	496S2500	0	\$ 45,765.30
Thomas	Mountain View	0.1	Mountain View	Mountain View	Crack Sealing	496S2504	012	\$ 3,181.36
Thomas	Hemphill/Aspin	0.1	Hemphill/Aspin	Hemphill/Aspin	Crack Sealing	496S2509	012	\$ 1,061.34
Thomas	Hunters Ridge	0.1	Hunters Ridge	Hunters Ridge	Crack Sealing	496S2510	031	\$ 4,325.16
Thomas	Thomas Farms	0.1	Thomas Farms	Thomas Farms	Crack Sealing	496S2513	011	\$ 3,242.54
Thomas	North Thomas	1.74	Geddes	Frost	Crack Sealing	496S2515	431	\$ 3,817.10
Thomas	Timber Acres	0.1	Timber Acres	Timber Acres	Crack Sealing	496S2524	011	\$ 832.58
Thomas	Rambling Acres	0.1	Rambling Acres Sub	Rambling Acres Sub	Crack Sealing	496S2524	012	\$ 3,818.18
Thomas	Short	0.1	Short	Short	Crack Sealing	496S2524	061	\$ 2,968.56
Thomas	Winchester Sub 1	0.1	Winchester Sub 1	Winchester Sub 1	Crack Sealing	496S2524	071	\$ 1,164.00
Thomas	Winchester Farms	0.1	Winchester Farms	Winchester Farms	Crack Sealing	496S2524	081	\$ 3,239.88
Thomas	Lutzke	0.1	Lutzke	Lutzke	Crack Sealing	496S2525	012	\$ 1,042.72
Birch Run	Various Roads	0.1	Various	Various	Hot Patching	49600200	0	\$ 38,742.36
Bridgeport	Various Roads	0.1	Various	Various	Hot Patching	49600600	0	\$ 12,525.12
Buena Vista	Various Roads	0.1	Various	Various	Hot Patching	49600700	0	\$ 3,757.11
Chapin	Various Roads	0.1	Various	Various	Hot Patching	49600900	0	\$ 16,019.16
Frankenmuth	Various Roads	0.1	Various	Various	Hot Patching	49601100	0	\$ 16,472.28
James	Various Roads	0.1	Various	Various	Hot Patching	49601300	0	\$ 20,568.69
Jonesfield	Various Roads	0.1	Various	Various	Hot Patching	49601400	0	\$ 25,178.26
Kochville	Various Roads	0.1	Various	Various	Hot Patching	49601500	0	\$ 18,299.95
Lakefield	Various Roads	0.1	Various	Various	Hot Patching	49601600	0	\$ 12,303.51
Maple Grove	Various Roads	0.1	Various	Various	Hot Patching	49601700	0	\$ 27,701.74
Richland	Various Roads	0.1	Various	Various	Hot Patching	49601900	0	\$ 21,320.08
Saginaw	Various Roads	0.1	Various	Various	Hot Patching	49602014	0	\$ 41,710.58
Swan Creek	Various Roads	0.1	Various	Various	Hot Patching	49602300	0	\$ 9,881.70
Taymouth	Various Roads	0.1	Various	Various	Hot Patching	49602400	0	\$ 10,412.10
Thomas	Various Roads	0.1	Various	Various	Hot Patching	49602500	0	\$ 12,774.40
Tittabawassee	Various Roads	0.1	Various	Various	Hot Patching	49602600	0	\$ 31,717.63
								\$ 1,062,349.98



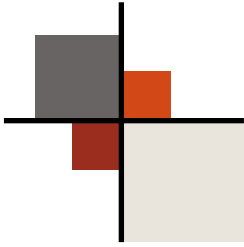

TOWNSHIP CONTRIBUTIONS

Township	Township Contributions
Albee	\$ 46,044.23
Birch Run	\$ 108,365.26
Blumfield	\$ 119,938.83
Brady	\$ 16,100.91
Brant	\$ 96,335.58
Bridgeport	\$ 93,001.99
Buena Vista	\$ 17,677.89
Carrollton	\$ 39,097.40
Chapin	\$ 39,356.85
Chesaning	\$ 47,956.03
Frankenmuth	\$ 85,126.77
Fremont	\$ 58,919.31
James	\$ 60,934.23
Jonesfield	\$ 33,716.42
Kochville	\$ 56,064.23
Lakefield	\$ 53,828.00
Maple Grove	\$ 177,781.94
Marion	\$ 70,989.68
Richland	\$ 35,011.00
Saginaw	\$ 75,700.24
St. Charles	\$ 39,510.28
Spaulding	\$ 1,533.32
Swan Creek	\$ 27,530.66
Taymouth	\$ 104,316.55
Thomas	\$ 496,774.28
Tittabawassee	\$ 122,020.14
Zilwaukee	\$ -
TOTAL:	\$ 2,123,632.02



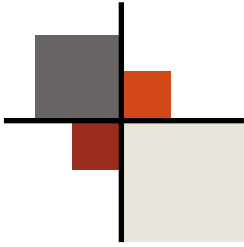

STATEMENT OF REVENUES & EXPENDITURES

	Primary Road Fund	Local Road Fund	Road Commission Fund	Total
REVENUES				
Michigan Transportation Fund	\$ 8,708,498.00	\$ 4,004,593.00		\$ 12,713,091.00
Optional Transfer	\$ (4,000,000.00)	\$ 4,000,000.00		\$ -
Critical Bridge Fund (State & Federal)	\$ 79,693.00	\$ 17,953.00		\$ 97,646.00
Other State Revenue	\$ 2,173,080.00	\$ 463,516.00		\$ 2,636,596.00
Rural Primary (D)				\$ -
Federal Revenue (STP)	\$ 1,072,219.00	\$ 536,000.00		\$ 1,608,219.00
Transportation & System Preservation	\$ 24,515.00			\$ 24,515.00
Other Federal			\$ 2,582.00	\$ 2,582.00
Gain on Disposal of Equipment	\$ 7,075.00	\$ 8,936.00	\$ 21,224.00	\$ 37,235.00
City/Village Contributions			\$ 93,518.00	\$ 93,518.00
Township Contributions	\$ 222,372.00	\$ 1,901,260.00		\$ 2,123,632.00
Other Govt. Entity Contributions			\$ 143,078.00	\$ 143,078.00
Charges for Services	\$ 9,825.00	\$ 63,863.00	\$ 24,563.00	\$ 98,251.00
Interest and Rents	\$ 874.00	\$ 5,504.00	\$ 15,777.00	\$ 22,155.00
Private/Public Sources, including Subdivisions		\$ 457,555.00		\$ 457,555.00
Special Assessments		\$ 107,790.00		\$ 107,790.00
Misc. Revenue	\$ 4,323.00	\$ 4,323.00	\$ 34,751.00	\$ 43,397.00
Other Financing Sources			\$ 353,095.00	\$ 353,095.00
TOTAL REVENUE:	\$ 8,302,474.00	\$ 11,571,293.00	\$ 688,588.00	\$ 20,562,355.00
EXPENDITURES				
Construction/Capacity Improvements	\$ 167,010.00	\$ 454,575.00		\$ 621,585.00
Preservation-Structural Improvements	\$ 2,545,614.00	\$ 2,548,437.00		\$ 5,094,051.00
Maintenance	\$ 3,605,757.00	\$ 6,208,129.00		\$ 9,813,886.00
Administrative	\$ 254,288.00	\$ 370,710.00		\$ 624,998.00
Equipment Account	\$ 117,653.00	\$ 213,687.00	\$ 11,201.00	\$ 342,541.00
Drain Assessments	\$ 20,451.00	\$ 61,353.00	\$ -	\$ 81,804.00
Debt Principal Payment	\$ 925,464.00		\$ 67,248.00	\$ 992,712.00
Interest Expense	\$ 49,694.00		\$ 7,756.00	\$ 57,450.00
Other (Non-Road Related Projects)			\$ 95,533.00	\$ 95,533.00
Net Capital Outlay	\$ 14,976.00	\$ (34,115.00)	\$ (458,874.00)	\$ (478,013.00)
TOTAL EXPENDITURES	\$ 7,700,907.00	\$ 9,822,776.00	\$ (277,136.00)	\$ 17,246,547.00
Revenues over(under) expenditures:	\$ 601,567.00	\$ 1,748,517.00	\$ 965,724.00	\$ 3,315,808.00
Fund Balance, Beginning of Year	\$ 219,219.00	\$ 1,355,712.00	\$ 3,982,531.00	\$ 5,557,461.00
FUND BALANCE, END OF YEAR	\$ 820,786.00	\$ 3,104,229.00	\$ 4,948,254.00	\$ 8,873,269.00



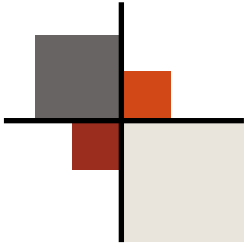

BALANCE SHEET

ASSETS

<u>General Operating Fund</u>		
Cash	\$	149,897
Investments	\$	5,551,239
Accounts Receivable (Includes MTF, Townships, Interest, etc.)	\$	3,445,565
<u>Inventories</u>		
Road Materials	\$	187,543
Equipment Materials and Parts	\$	70,881
<u>Prepays</u>		
Prepaid Expenses	\$	154,224
Salt	\$	606,318
<u>Long-term Assets</u>		
Special Assessments	\$	365,299
Total General Operating Assets		\$ 10,530,966
<u>Capital Asset Account Group</u>		
Land	\$	558,635
Land Improvements	\$	31,196
Depletable Assets	\$	31,099
Buildings	\$	512,286
Road Equipment	\$	1,706,672
Shop Equipment	\$	2,924
Engineering Equipment	\$	104,951
Yard & Storage Equipment	\$	2,292
Office Equipment	\$	60,358
Infrastructure	\$	155,380,167
Net Fixed Assets		\$ 158,390,580
TOTAL ASSETS		\$ 168,921,546

LIABILITIES & FUND BALANCES

<u>General Operating Fund</u>		
Accounts Payable	\$	311,449
Accrued Liability	\$	142,564
Due to State	\$	(13,785)
Due to Former Employees	\$	15,384
Prepaid Permits	\$	3,505
Performance Deposits	\$	165,331
Accrued MERS Payable	\$	44,491
Total Liabilities		\$ 668,938
<u>Deferred Inflows</u>		
Unavailable Special Assessments	\$	410,898
Unavailable Local Agency Disbursements	\$	577,861
Total Deferred Inflows		\$ 988,759
<u>Fund Balances</u>		
Primary	\$	820,787
Local	\$	3,104,128
County	\$	4,948,354
Total Fund Balance		\$ 8,873,269
<u>Capital Asset Account Group</u>		
Plant & Equipment Equity		\$ 158,390,580
TOTAL LIABILITIES & FUND BALANCES		\$ 168,921,546



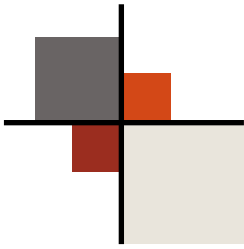

ORGANIZATIONAL CHART

